



LEGEND		
ITEM	EXISTING	ULTIMATE
AIRPORT REFERENCE POINT (A.R.P.)		
ANTENNA		
BLUFF		
BUILDINGS		
BUILDING RESTRICTION LINE		
FENCE		
PAPI		
PROPERTY LINE		
REIL		
ROADWAYS		
ROTATING BEACON		
SHORELINE		
SURVEY MONUMENT		
THRESHOLD MARKERS/LIGHTS		
TOPOGRAPHIC CONTOURS		
TREE (LARGE SINGLE)		
TREELINE		
VASI		
WIND CONE		
WIND CONE AND SEGMENTED CIRCLE		

AIRPORT DATA TABLE		
ITEM	EXISTING	ULTIMATE
ICAO IDENTIFIER	NONE	NONE
NATIONAL AIRPORT IDENTIFIER	KWT	KWT
FAA SITE NUMBER	50438.5*A	50438.5*A
AIRPORT ELEVATION (MSL NAVD88)	17.8'	17.8'
AIRPORT REFERENCE CODE	B-II UTILITY	B-II UTILITY
MEAN MAX. TEMPERATURE, HOTTEST MONTH	55.9 F JULY	55.9 F JULY
AIRPORT AND TERMINAL NAVIGATION AIDS	ROTATING BEACON	ROTATING BEACON
TAXIWAY LIGHTING/MARKING	M.I. / N/A	M.I. / N/A
OBSTRUCTION SURVEY SOURCE & TYPE	NONE	ANP
MAGNETIC DECLINATION, YEAR, RATE OF CHANGE	15°7'E, 2005, -0°12' (W)/YEAR	

GEOGRAPHIC COORDINATES TABLE				
ITEM	EXISTING LATITUDE	EXISTING LONGITUDE	ULTIMATE LATITUDE	ULTIMATE LONGITUDE
ARP	60°47'25"N	161°26'37"W	60°47'25"N	161°26'37"W
THRESHOLD RW 18	60°47'40.37"N	161°26'28.44"W	60°47'40.37"N	161°26'28.44"W
THRESHOLD RW 36	60°47'10.08"N	161°26'46.14"W	60°47'10.08"N	161°26'46.14"W

RUNWAY 18/36 DATA TABLE		
ITEM	EXISTING	ULTIMATE
RUNWAY TYPE	ENTER UTILITY OR >UTILITY	UTILITY
FAR PART 77 APPROACH CATEGORY (V, NPI, P)	NPI	NPI
APPROACH SURFACES	20:1 / 20:1	20:1 / 20:1
VISIBILITY MINIMUM	1 SM	1 SM
RUNWAY SURFACE	GRAVEL	GRAVEL
RUNWAY STRENGTH SW,DW,DTW,DDTW 1000lbs	12, 20, N/A, N/A	12, 20, N/A, N/A
AIRCRAFT APPROACH CATEGORY	B	B
AIRCRAFT DESIGN GROUP	II	II
RUNWAY DIMENSIONS	75'x3,199'	75'x3,199'
TRUE BEARING	N15°56'14"E	N15°56'14"E
EFFECTIVE GRADE	0 %	0 %
TOUCHDOWN ELEVATION (NAVDBB)	17.8' / 17.8'	17.8' / 17.8'
RUNWAY SAFETY AREA (RSA)	150'x3,799'	150'x3,799'
LENGTH BEYOND R/W END	300' / 300'	300' / 300'
RUNWAY PROTECTION ZONE (RPZ)	500'x700'x1000'	500'x700'x1000'
RUNWAY OBJECT FREE AREA (OFA)	500'x3,799'	500'x3,799'
RUNWAY OBSTACLE FREE ZONE (OFZ)	250'x3,599'	250'x3,599'
RUNWAY LIGHTING	M.I.	M.I.
RUNWAY MARKING TYPE	NONE	NONE
RUNWAY VISUAL APPROACH AIDS	REIL / PAPI, REIL	PAPI, REIL / PAPI, REIL

Date Plotted: 9/23/2005, 7:28 AM
 Layout Name: 1=1, layout=1
 File Name: W:\Projects\Kwethluk\ALP - As-Built - 2005.dwg, Data Sheet.cwg
 Designed By: R. Robertson
 Drawn By: W. Tolman
 Checked By: R. Crell

NOTE
 1. RUNWAY ELEVATION BASED ON RECORD OF SURVEY 3/31/05

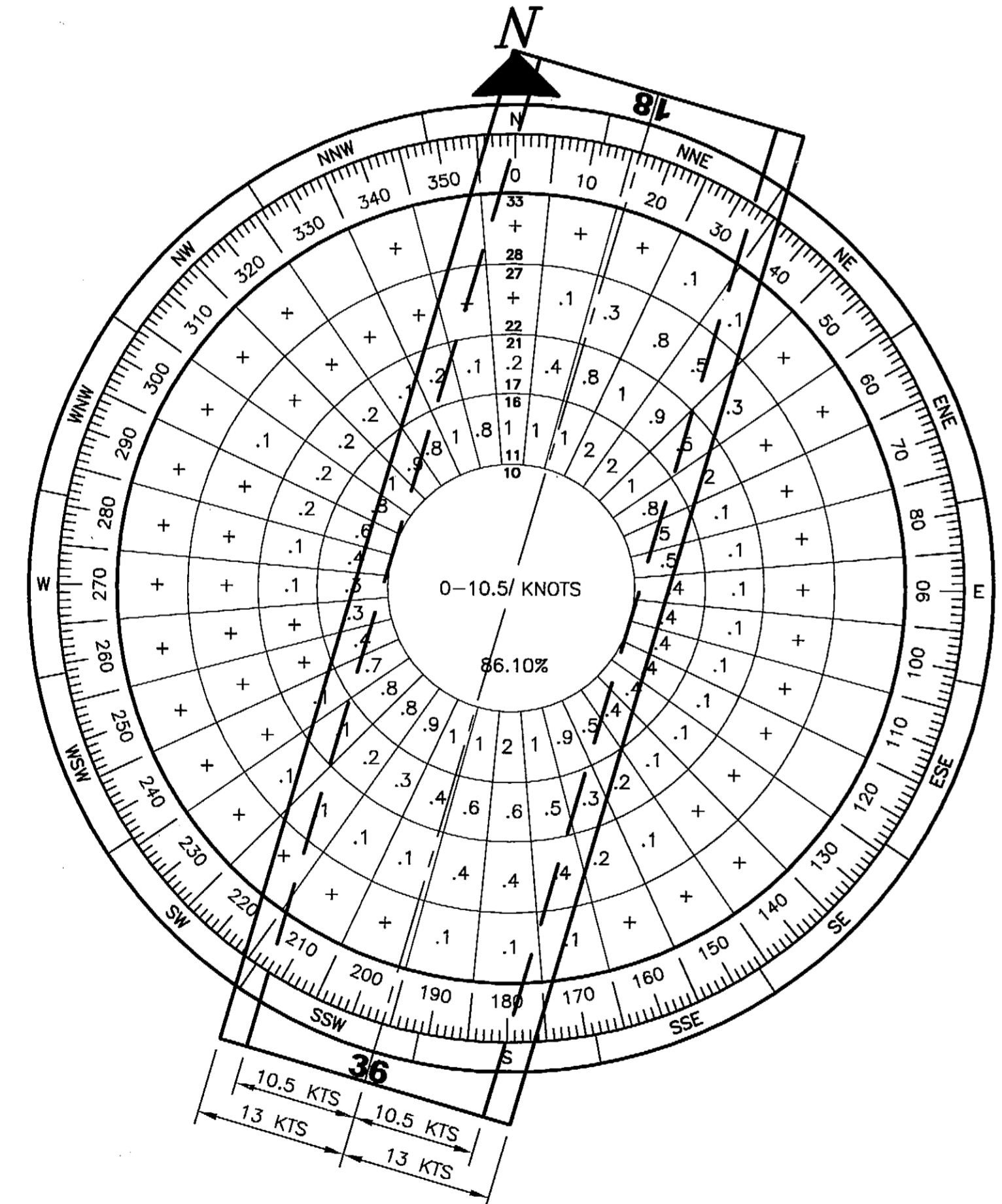

WIND DATA TABLE				
RUNWAY	10.5 kt	13 kt	16 kt	20 kt
18/36	88.93%	92.91%	-	-

SOURCE: ALASKA STATE CLIMATE CENTER, E.N.R.I. UNIVERSITY OF ALASKA ANCHORAGE
 DATA IS FOR BETHEL ALASKA WHICH IS LOCATED 19 km WEST OF KWETHLUK
 PERIOD: 12/86-12/95

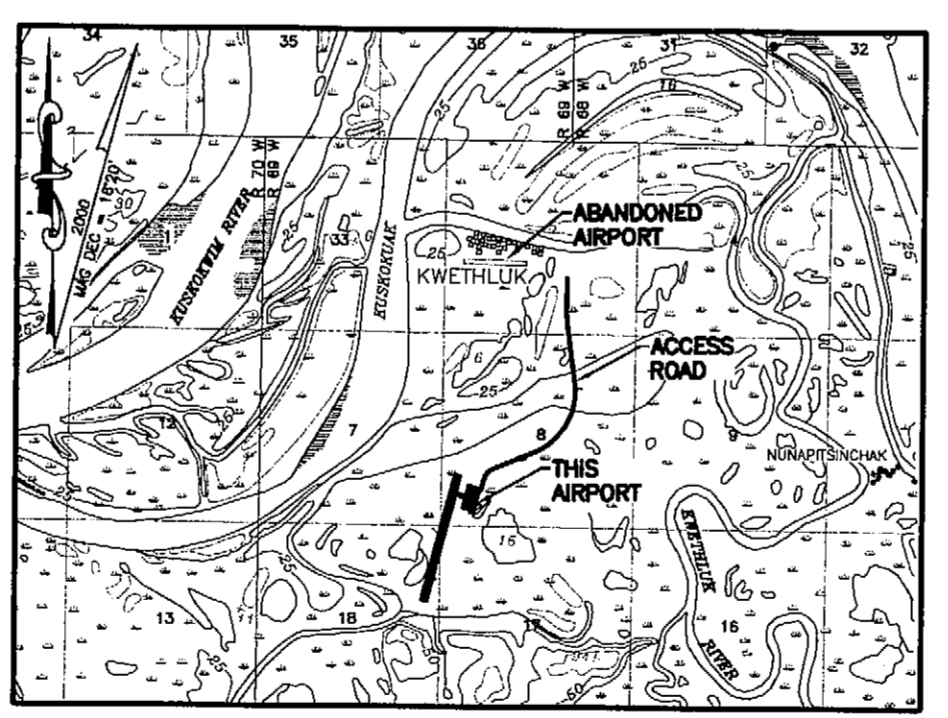

1 SM .5 SM 0 1 SM 2 SM
 T 8 N, R 69 W, SEC. 8, 17, AND 18
 SEWARD MERIDIAN
 U.S.G.S. BETHEL (D-7), ALASKA

MODIFICATION TO STANDARDS/ NON STANDARD CONDITIONS			
DESCRIPTION	STANDARD	EXISTING	ULTIMATE
LANDFILL SEPARATION	5,000'	3,840'	5,000'
THRESHOLD LIGHTING	8 LIGHTS	6 LIGHTS	8 LIGHTS

DRAWING INDEX	
SHT #	TITLE
1	WIND ROSE, DATA TABLES, LOCATION MAP & VICINITY MAP
2	AIRPORT LAYOUT PLAN
3	INNER PORTION OF THE APPROACH SURFACES
4	AIRPORT AIRSPACE
5	PROPERTY MAP

APPROVED:	DATE: 9-27-05
RECOMMENDED:	DATE: 26 SEP 05
DESIGN SECTION CHIEF:	DATE: 11/10/05

STATE OF ALASKA DEPARTMENT OF TRANSPORTATION AND PUBLIC FACILITIES CENTRAL REGION	
KWETHLUK AIRPORT KWETHLUK, ALASKA AIRPORT LAYOUT PLAN WIND ROSE, DATA TABLES LOCATION MAP VICINITY MAP	DATE: 09/19/05 SHEET: 1 OF 5

Date Plotted: 9/23/2005, 7:59 AM
 Layout Name: 1=1, layout=Prp
 File Name: W:\Projects\kwethluk\ALP - As-Built_4-2005.dwg, prp.dwg
 Designed By: R. Robertson
 Drawn By: M. Tolman
 Checked By: R. Kiehl

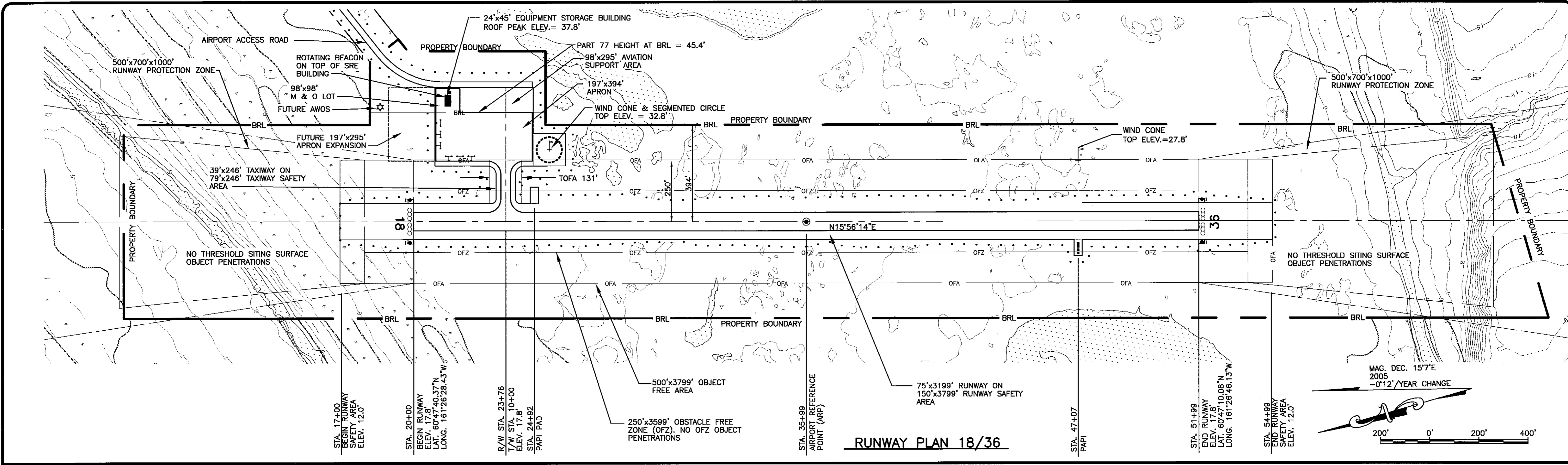

BUILDING DATA TABLE

ID #	DISCRIPTION	STATION & OFFSET	TOP ELEV.	OBSTRUCTION
1	EQUIPMENT STORAGE BUILDING 24'x 45'	R/W STA. 21+39 OFFSET: 469 L.T.	37.8'	NONE

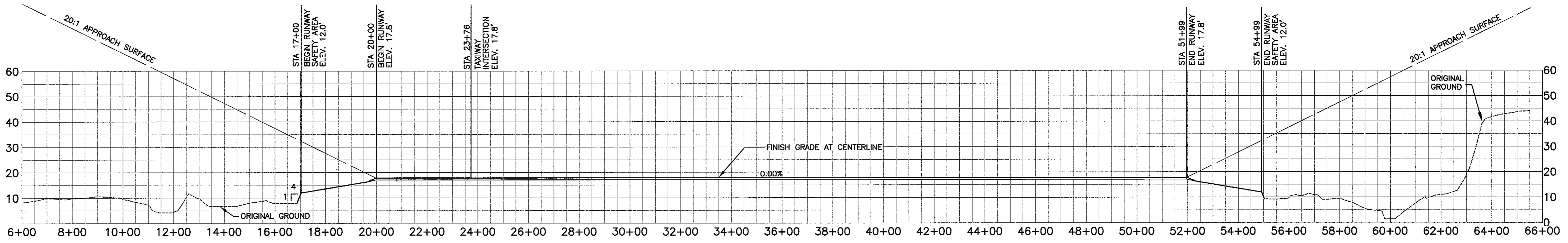

RUNWAY PROFILE 18/36

BY	DATE	REVISION

STATE OF ALASKA
DEPARTMENT OF TRANSPORTATION
AND PUBLIC FACILITIES
CENTRAL REGION

KWETHLUK AIRPORT
 KWETHLUK, ALASKA
 AIRPORT LAYOUT PLAN

DATE: 09/19/05
 SHEET: 2 OF 5

Date Plotted: 9/23/2005, 9:06 AM
 Layout Name: 1=1, layout=Approach
 File Name: W:\Projects\Kwethluk\ALP - As-Built\4-2005.dwg, pnp.dwg
 Designed By: R. Robertson
 Drawn By: M. Tolman
 Checked By: R. Kehl

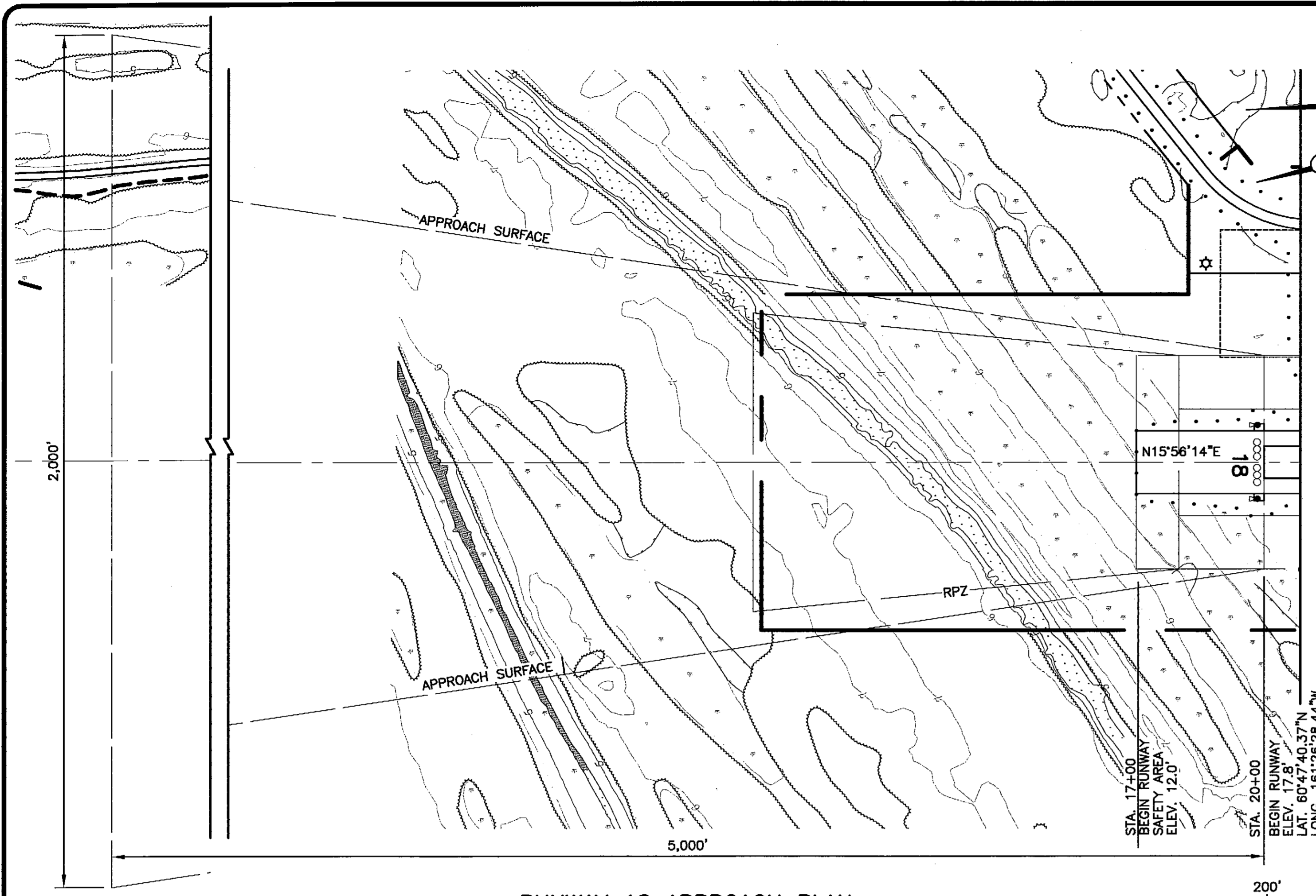

RUNWAY 18 APPROACH PLAN

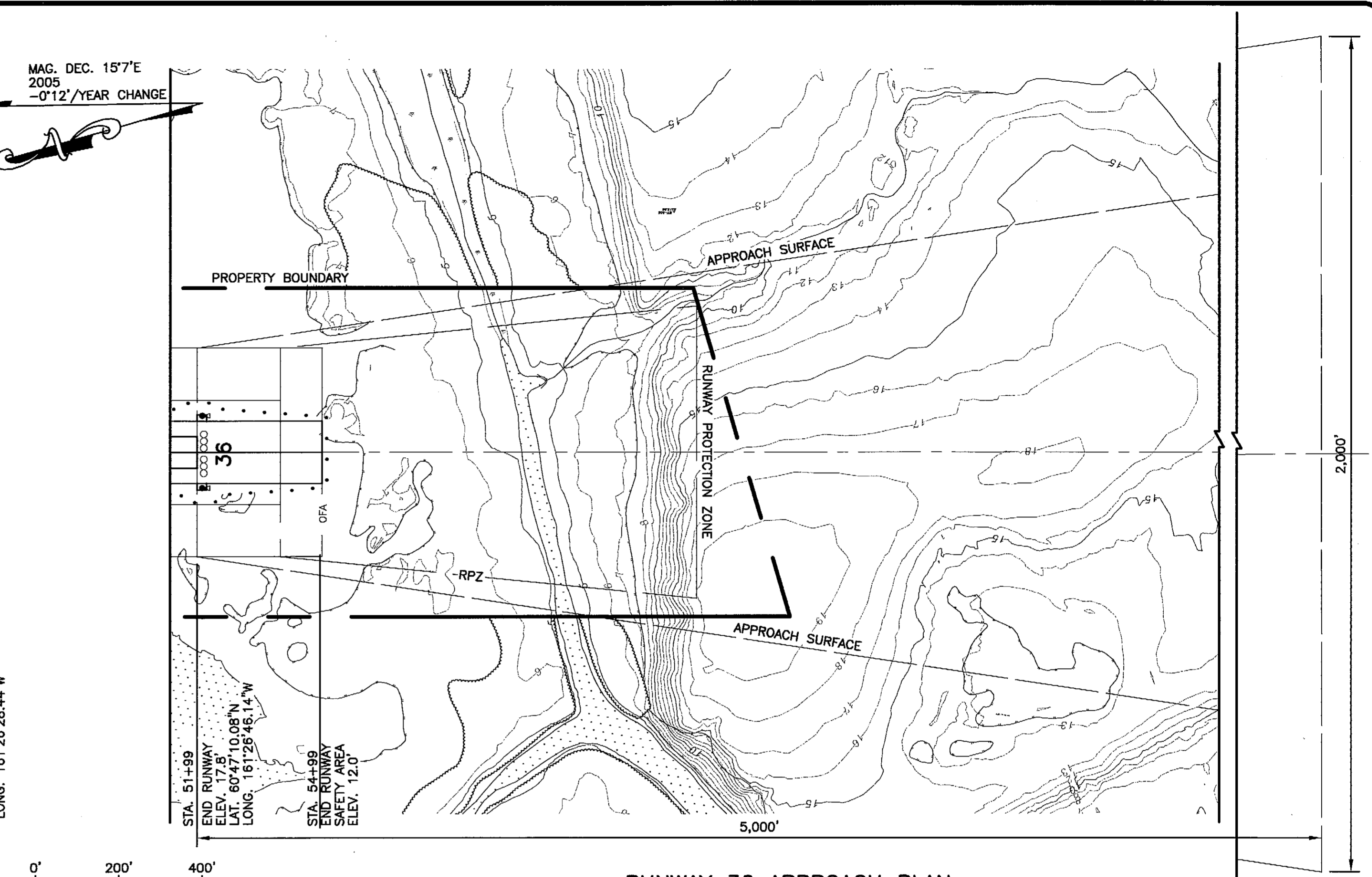

RUNWAY 36 APPROACH PLAN

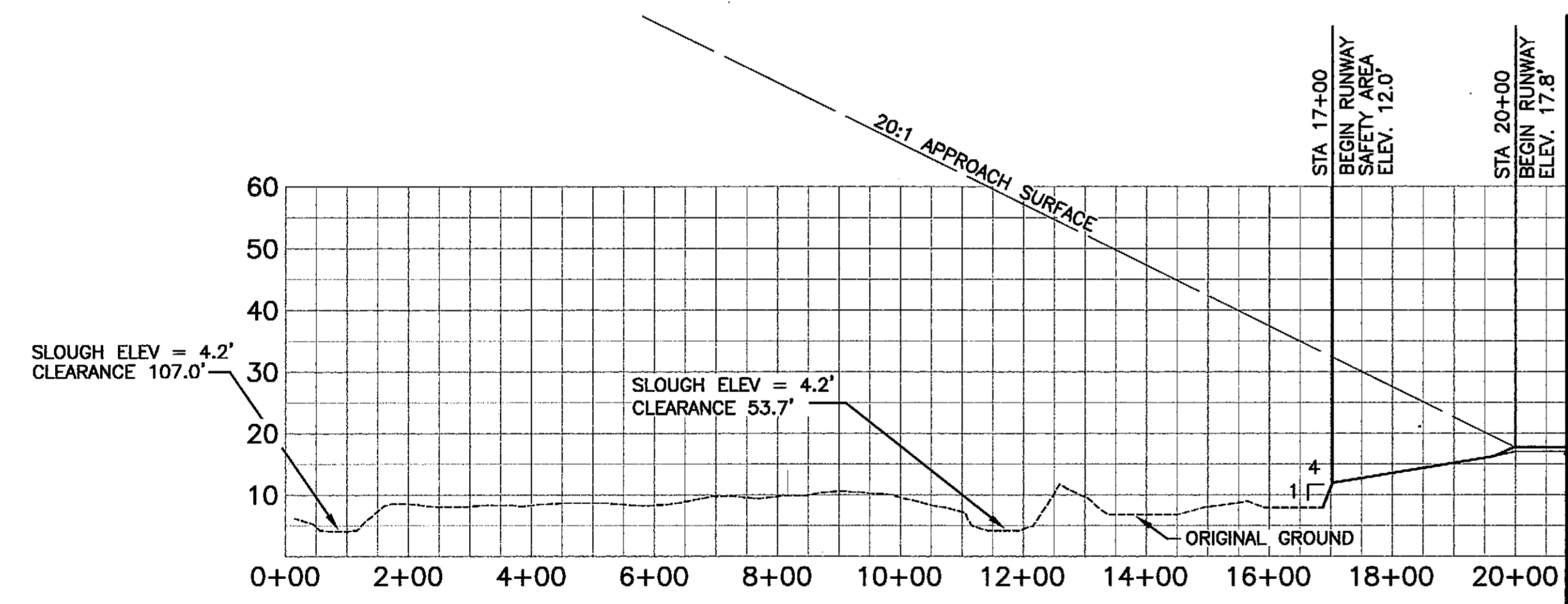

RUNWAY 18 APPROACH PROFILE

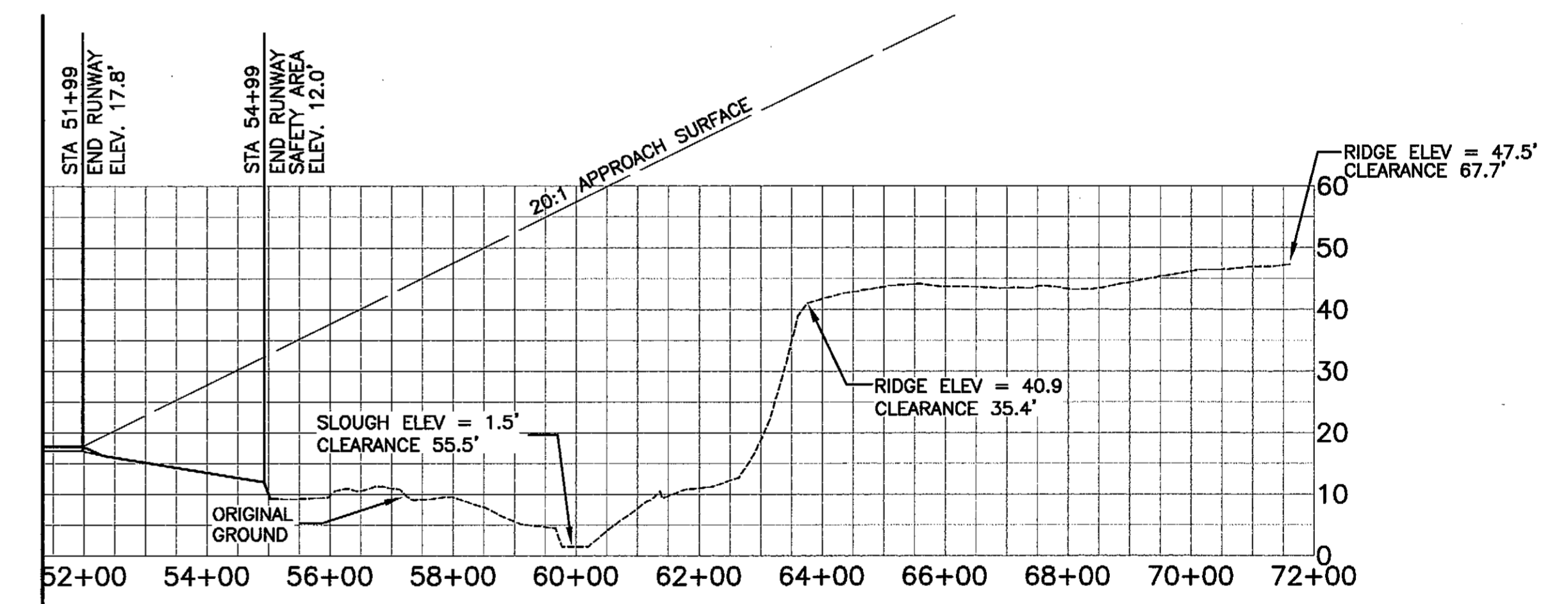

RUNWAY 36 APPROACH PROFILE

NUMBER	PENETRATION DISTANCE		DESCRIPTION	DISPOSITION
	DISTANCE	SURFACE PENETRATED		
NONE	NONE	NONE	NONE	N/A

NUMBER	PENETRATION DISTANCE		DESCRIPTION	DISPOSITION
	DISTANCE	SURFACE PENETRATED		
NONE	NONE	NONE	NONE	N/A

NOTE:

1. NO PENETRATIONS TO RUNWAYS 18 AND 36 APPROACH SLOPES.
2. SEE AIRPORT AIRSPACE FOR PENETRATIONS OF THE TRANSITIONAL SURFACE AND PRIMARY SURFACE.
3. NO THRESHOLD SITING SURFACE OBJECT PENETRATIONS.
4. NO OFZ PENETRATIONS.
5. OBSTRUCTION CLEARANCE SLOPE GREATER THAN 50:1 FOR RUNWAY 18.
6. OBSTRUCTION CLEARANCE SLOPE 50:1 FOR RUNWAY 36, CONTROLLING OBSTRUCTION IS RIDGE LOCATED 1230' FROM THRESHOLD.
7. CONTOURS ARE IN METRIC.
8. THERE ARE NO OBJECT PENETRATIONS IN THE THRESHOLD SITING SURFACES OF RUNWAY 18/36, AS DEFINED IN FAA AC150/5300-13, CHG 8, APPENDIX 2, PARAGRAPH 5e.

BY	DATE	REVISION

STATE OF ALASKA
DEPARTMENT OF TRANSPORTATION
AND PUBLIC FACILITIES
CENTRAL REGION

KWETHLUK AIRPORT
 KWETHLUK, ALASKA
 AIRPORT LAYOUT PLAN
 INNER PORTION OF THE
 APPROACH SURFACES

DATE:
 09/19/05
 SHEET:
 3
 OF
 5

Date Plotted: 9/23/2005, 7:43 AM
 Layout Name: 11-1
 File Name: W:\Projects\Kwethluk\ALP - As-built 4-2005\dwg\part77.dwg
 Designed By: R. Robertson
 Drawn By: M. Tolmon
 Checked By: R. Kiehl

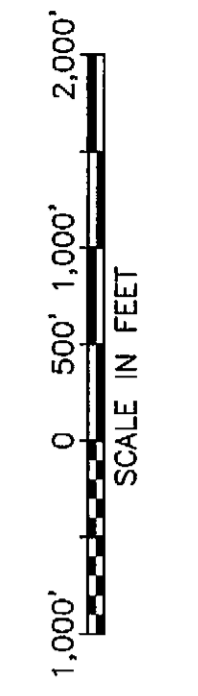
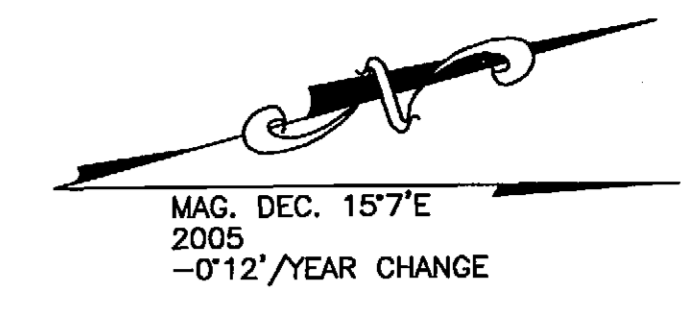
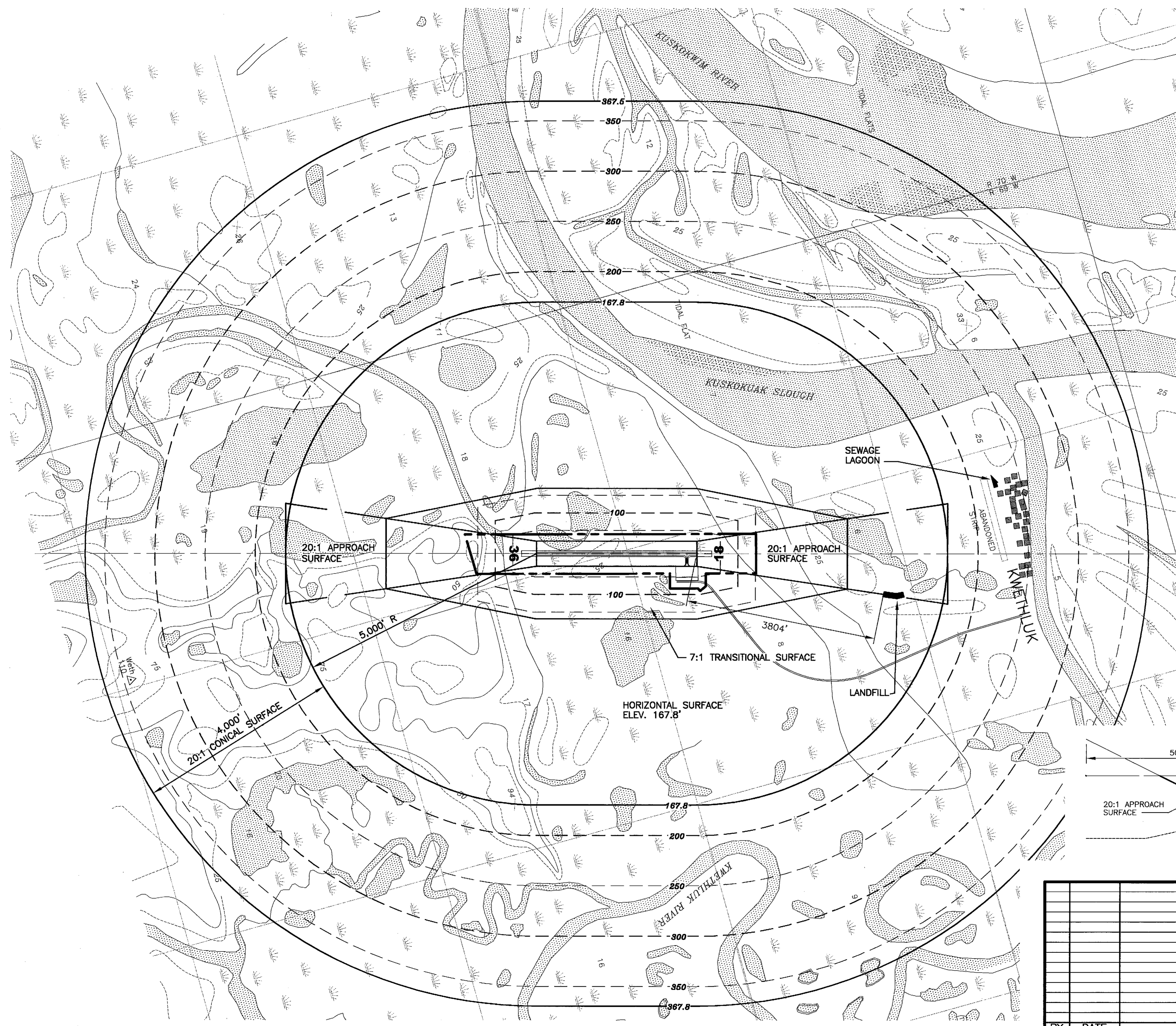

NUMBER	OBSTRUCTION DATA TABLE		DISPOSITION
	PENETRATION DISTANCE	DESCRIPTION	
	DISTANCE	SURFACE PENETRATED	
		NONE	

LEGEND

WATER SURFACE
X Feet SPOT ELEVATIONS

- NOTES**
- AIRPORT AND RUNWAY ELEVATIONS ARE 17.8'
 - TO CONVERT GROUND CONTOURS TO NAVD 88 SUBTRACT 11.61'
 - BASE MAP IS FROM U.S.G.S. BETHEL (D-7), ALASKA.
 - PRIMARY SURFACE WIDTH IS 500'.
 - NO KNOWN HEIGHT RESTRICTIONS.
 - REFER TO INNER PORTIONS OF THE APPROACH SURFACE FOR CLOSE IN OBSTRUCTIONS.
 - PART 77 ELEVATIONS AND CONTOURS BASED ON NAVD 88

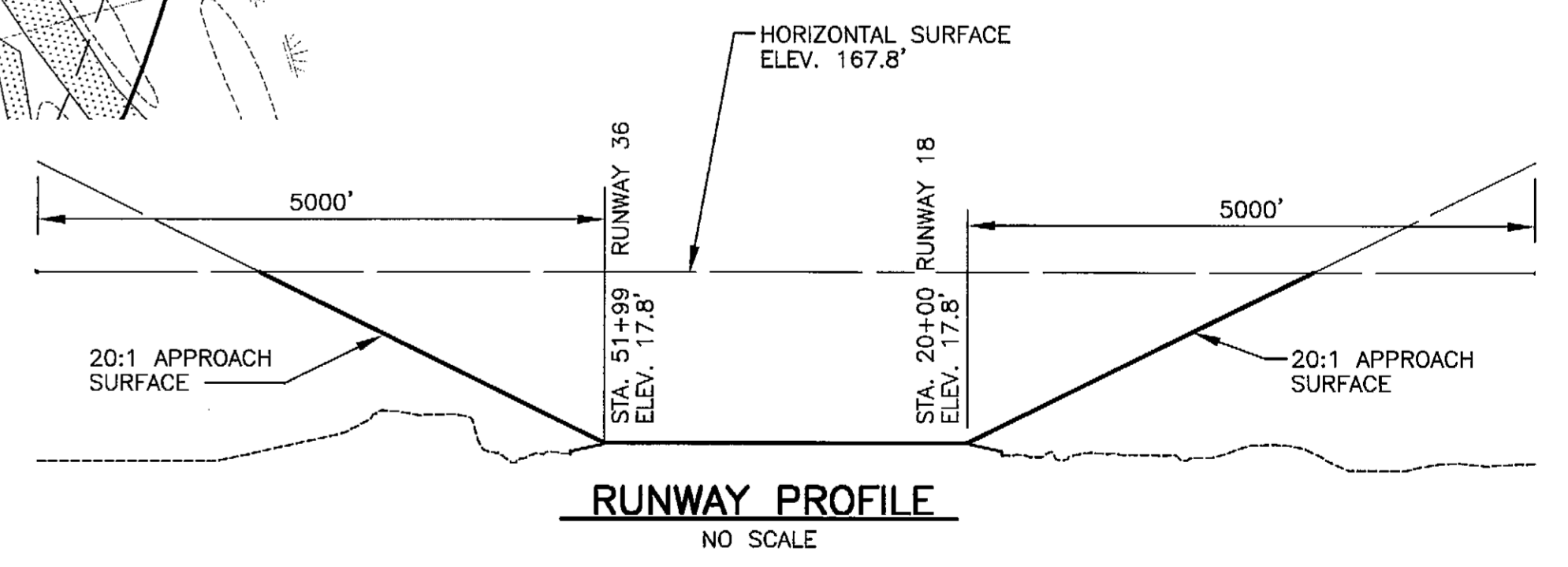

BY	DATE	REVISION

STATE OF ALASKA
DEPARTMENT OF TRANSPORTATION
AND PUBLIC FACILITIES
CENTRAL REGION

KWETHLUK AIRPORT
 KWETHLUK, ALASKA
 AIRPORT LAYOUT PLAN
 AIRPORT AIRSPACE

DATE: 09/19/05
 SHEET: 4 OF 5

