



Federal Aviation Administration

September 25, 2017

TO:
State of Alaska
Attn: Joel St. Aubin
PO Box 196900
Anchorage, AK 99519
joel.st.aubin@alaska.gov

RE: (See attached Table 1 for referenced case(s))
FINAL DETERMINATION

Table 1 - Letter Referenced Case(s)

Table with 7 columns: ASN, Prior ASN, Location, Latitude (NAD83), Longitude (NAD83), AGL (Feet), AMSL (Feet). Row 1: 2017-AAL-160-NRA, HOPE, AK, 60-54-26.00N, 149-37-22.00W, 0, 194

The Federal Aviation Administration (FAA) conditionally approves your Airport Layout Plan (ALP) for Hope, AK dated 09/26/2017. This approval is subject to the condition that the proposed airport development listed below requires environmental processing and may not be undertaken without the FAA's prior written environmental approval:

None of the proposed development shown on the ALP has received environmental clearance. Any development, regardless of funding source, that constitutes a change to this ALP requires environmental clearance.

The ALP received a favorable airspace determination and is subject to the conditions described in this airspace determination letter 2017-AAL-160-NRA, dated 09/25/2017. Although future structures on or near the airport may be in conformance with the ALP, this determination does not extend to them. Therefore, all future structures will be subject to the notice provisions of Title 14 Code of Federal Regulations (CFR) Part 77, Objects Affecting Navigable Airspace.

We find the proposed airport development shown on the ALP acceptable from the standpoint of safety, efficiency and utility.

Our approval does not represent a commitment to provide federal financial assistance to implement any development or air navigation facilities shown on the plan, nor does it mean that we find funding of the proposed airport development justified.

We look forward to working with you in the continued development of your airport. If you have any questions, please contact [Mike Edelmann, Aviation Planner at \(907\) 271-5026 Mike.Edelmann@faa.gov](mailto:Mike.Edelmann@faa.gov).



Kristi Warden,
Deputy Division Manager
FAA Airports Division, Alaskan Region

Date Plotted: 8/18/2017, 3:16 PM
 Layout Name: Airport Data
 File Name: W:\Projects\Hope\ALP\ALP_Update_2015\Final Drawings\Hope_ALP_2016.dwg
 Designed By: PWC
 Drawn By: PWC
 Checked By: ---

AIRPORT DATA		
ITEM	EXISTING	ULTIMATE
ICAO IDENTIFIER	NONE	NONE
NATIONAL AIRPORT IDENTIFIER	5HO	5HO
FAA SITE NUMBER	50324,*A	50324,*A
AIRPORT ELEVATION NAVD88	193.9	193.9
AIRPORT REFERENCE CODE	A-I (S)	A-I (S)
MEAN MAX. TEMPERATURE, HOTTEST MONTH	66.7 F	66.7 F
MAGNETIC DECLINATION, YEAR, RATE OF CHANGE	18°33'E, 2017, -0'20' (W)/YEAR	
CRITICAL AIRCRAFT OR AIRCRAFT GROUP	A-I (S)	A-I (S)
AIRPORT AND TERMINAL NAVIGATION AIDS	SEGMENTED CIRCLE WINDCONE	SEGMENTED CIRCLE WINDCONE
NPIAS SERVICE LEVEL	GA	GA
STATE EQUIVALENT SERVICE ROLE	COMMUNITY ON-ROAD	COMMUNITY ON-ROAD

GEOGRAPHIC COORDINATES		
ITEM	EXISTING	ULTIMATE
ARP		
LATITUDE	60°54'26"	60°54'26"
LONGITUDE	149°37'22"	149°37'22"
THRESHOLD RW 17		
LATITUDE	60°54'36.08"	60°54'36.08"
LONGITUDE	149°37'19.64"	149°37'19.64"
ELEVATION	159.3	159.3
THRESHOLD RW 35		
LATITUDE	60°54'16.14"	60°54'16.14"
LONGITUDE	149°37'24.60"	149°37'24.60"
ELEVATION	193.9	193.9

RUNWAY 17/35 DATA		
ITEM	EXISTING	ULTIMATE
RUNWAY TYPE	UTILITY OR OTHER THAN UTILITY	UTILITY
FAR PART 77 APPROACH CATEGORY (V, NPI, P)	V / V	V / V
FAR PART 77 VISIBILITY MINIMUM	VIS / VIS	VIS / VIS
FAR PART 77 APPROACH SURFACES SLOPE	20:1 / 20:1	20:1 / 20:1
APPROACH TYPE (VIS, NPA, APV(NP), APV(P), PREC)	VIS / VIS	VIS / VIS
THRESHOLD SITING SURFACE SLOPE	20:1 / 20:1	20:1 / 20:1
RUNWAY DESIGN CODE	A-(S)-VIS	A-(S)-VIS
APPROACH RUNWAY REFERENCE CODE (APRC)	B-(S)-VIS	B-(S)-VIS
DEPARTURE RUNWAY REFERENCE CODE (DPRC)	B-(S)	B-(S)
RUNWAY SURFACE	GRAVEL	GRAVEL
SURFACE TREATMENT	N/A	N/A
AIRPLANE GEAR CONFIG/PAVE STRENGTH (x1000lbs)	N/A	N/A
PAVEMENT STRENGTH BY PCN	N/A	N/A
DESIGN AIRCRAFT (>60,000 lbs)	N/A	N/A
MAXIMUM ELEVATION	193.9	193.9
TOUCHDOWN ZONE ELEVATION NAVD88	193.9	193.9
EFFECTIVE GRADE	1.70%	1.70%
MEAN GEODETIC BEARING	N 6.90° E	N 6.90° E
RUNWAY DIMENSIONS	60' X 2040'	60' X 2040'
RUNWAY SAFETY AREA (RSA)	120' X 2520'	120' X 2520'
RSA LENGTH BEYOND DEPARTURE END	240'	240'
RSA LENGTH PRIOR TO THRESHOLD	240'	240'
RUNWAY OBJECT FREE AREA (OFA)	250' X 2520'	250' X 2520'
ROFA LENGTH BEYOND DEPARTURE END	240'	240'
ROFA LENGTH PRIOR TO THRESHOLD	240'	240'
RUNWAY OBSTACLE FREE ZONE (OFZ)	250' X 2440'	250' X 2440'
PRECISION OBSTACLE FREE ZONE (POFZ)	N/A	N/A
RUNWAY PROTECTION ZONE (RPZ)	250' X 450' X 1000'	250' X 450' X 1000'
RUNWAY LIGHTING	NONE	NONE
RUNWAY MARKING TYPE	NONE	NONE
RUNWAY NAVIGATIONAL AIDS	NONE	NONE
AERONAUTICAL SURVEY TYPE REQUIRED	NVG	NVG
DEPARTURE SURFACE	N/A	N/A

TAXIWAY "A" DATA		
ITEM	EXISTING	ULTIMATE
AIRPLANE DESIGN GROUP	A-I	A-I
TAXIWAY DESIGN GROUP	1A	1A
TAXIWAY SURFACE	GRAVEL	GRAVEL
LENGTH x WIDTH	184 x 25	685 x 25
SHOULDER WIDTH	10	10
SAFETY AREA (TSA) WIDTH	49	49
EDGE SAFETY MARGIN (TESM)	5	5
OBJECT FREE AREA (TOFA) WIDTH	89	89
TAXIWAY LIGHTING	NONE	NONE
TAXIWAY MARKING	NONE	NONE

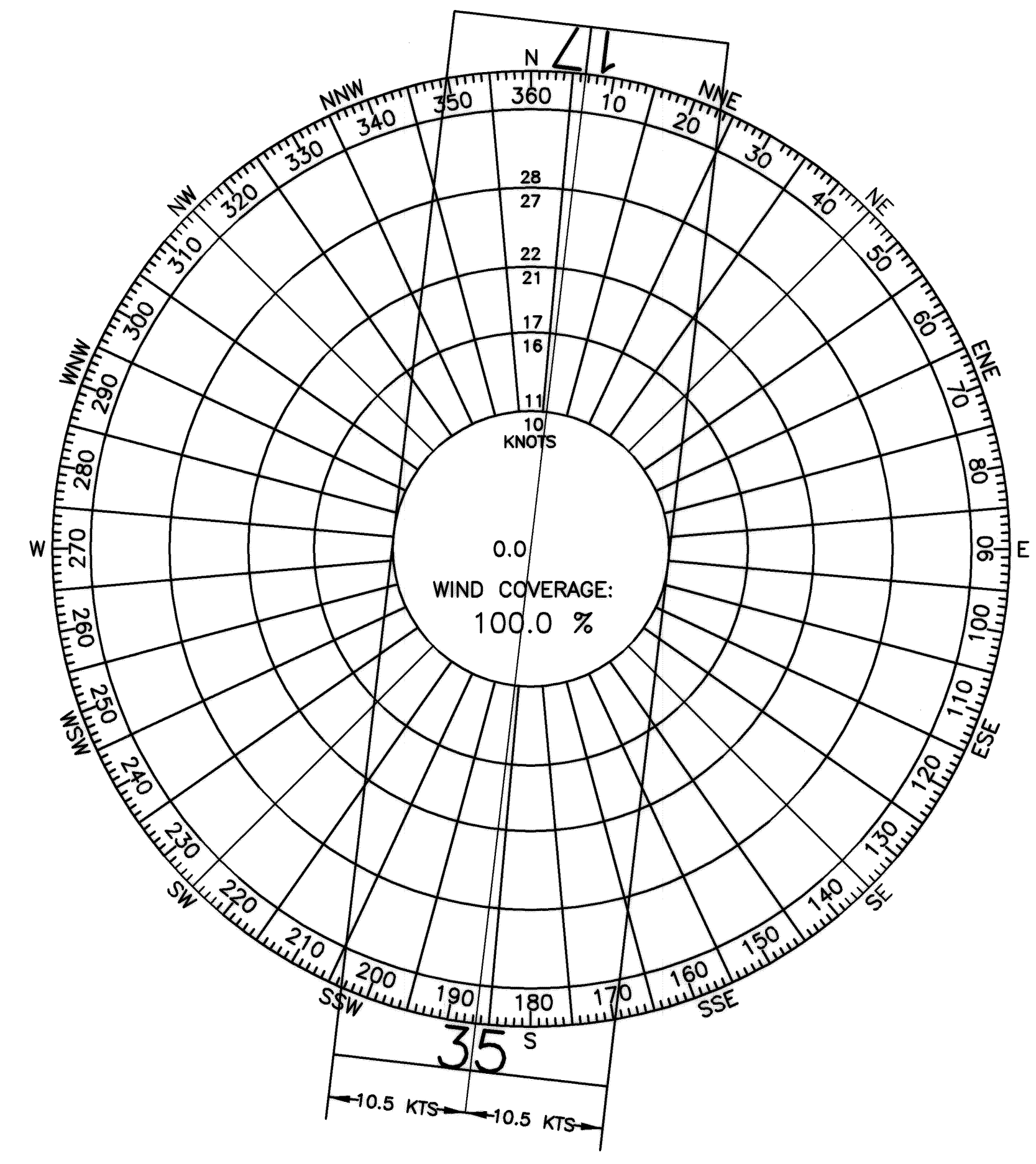

RW 17/35 WIND DATA				
RUNWAY	10.5 kt	13 kt	16 kt	20 kt

NOTE: WIND DATA NOT AVAILABLE

- NOTES:
1. ALL LATITUDE/LONGITUDE COORDINATES ARE NAD83.
 2. ALL ELEVATIONS ARE NAVD88.
 3. MAPPING BASED ON DOT SURVEY 2015.

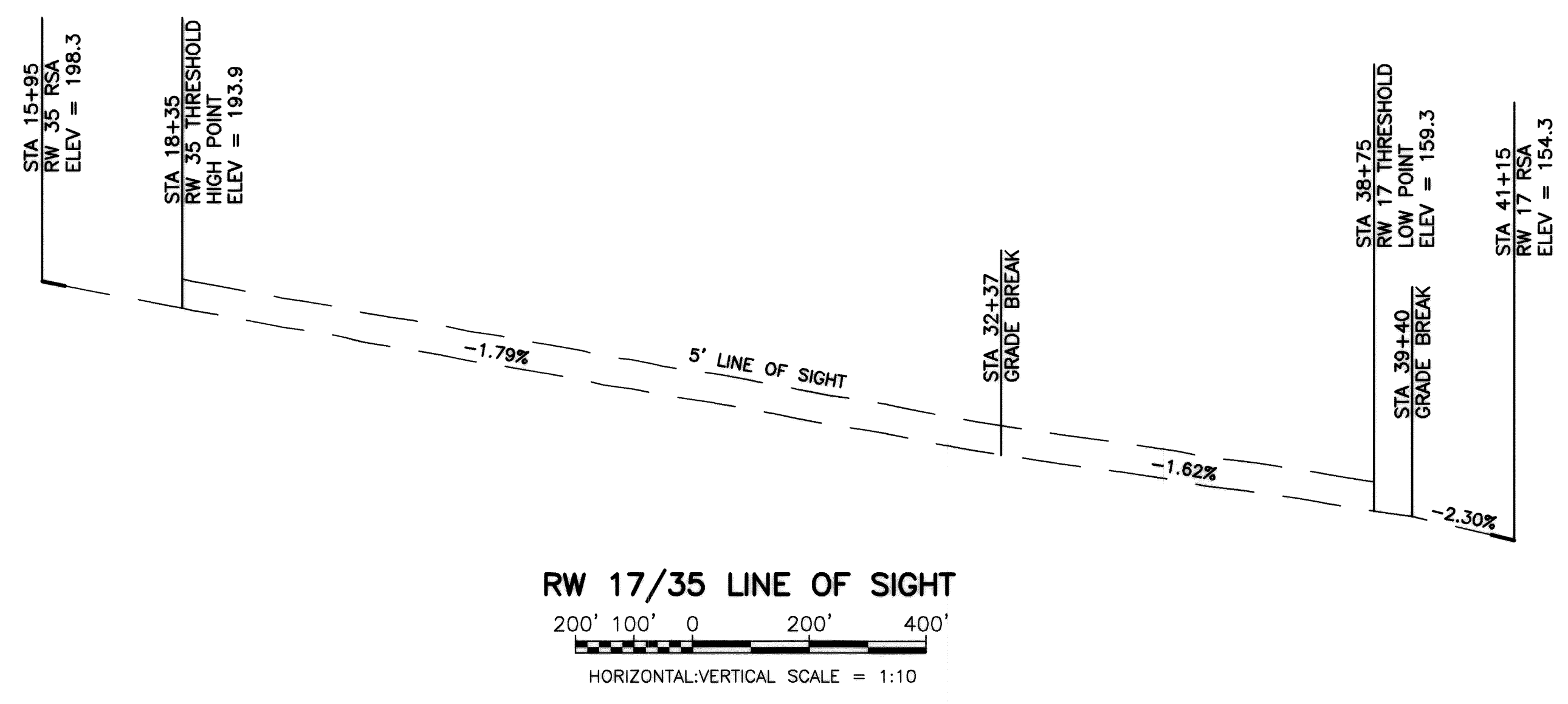

RW 17/35 LINE OF SIGHT
 200' 100' 0 200' 400'
 HORIZONTAL:VERTICAL SCALE = 1:10

BY		DATE		REVISION	
STATE OF ALASKA DEPARTMENT OF TRANSPORTATION AND PUBLIC FACILITIES CENTRAL REGION					
HOPE AIRPORT HOPE, ALASKA AIRPORT LAYOUT PLAN				DATE: 9/12/2016 SHEET: 2 OF 7	
AIRPORT DATA					

Date Plotted: 8/18/2017, 3:20 PM
 Layout Name: E:\Projects\Hope\ALP_2016.dwg
 File Name: W:\Projects\Hope\ALP_Update_2015\Final Drawings\Hope_ALP_2016.dwg
 Designed By: PWC
 Drawn By: PWC
 Checked By: PWC

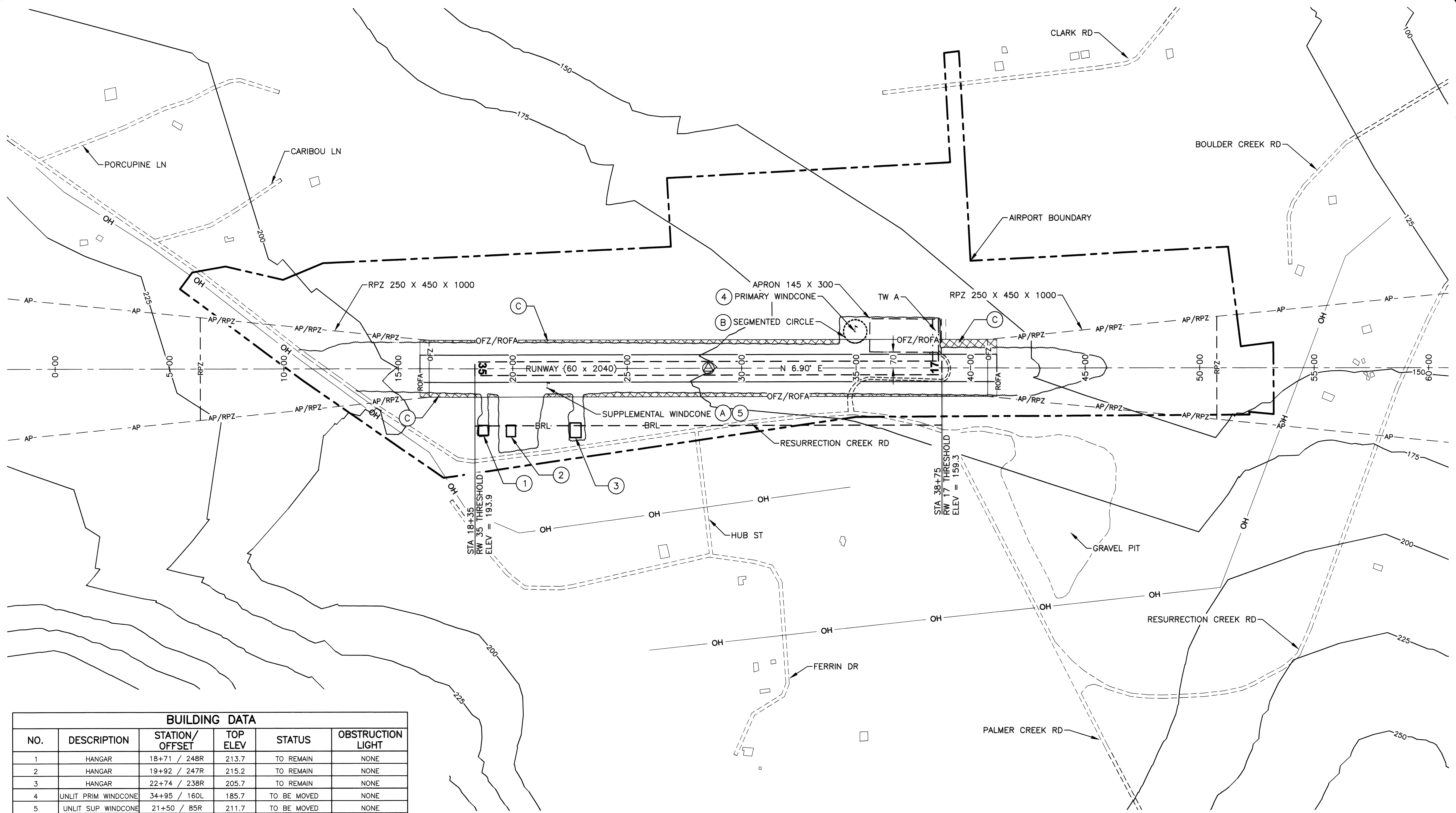

BUILDING DATA					
NO.	DESCRIPTION	STATION/OFFSET	TOP ELEV	STATUS	OBSTRUCTION LIGHT
1	HANGAR	18+71 / 248R	213.7	TO REMAIN	NONE
2	HANGAR	19+92 / 247R	215.2	TO REMAIN	NONE
3	HANGAR	22+74 / 238R	205.7	TO REMAIN	NONE
4	UNLIT PRIM WINDCONE	34+95 / 160L	185.7	TO BE MOVED	NONE
5	UNLIT SUP WINDCONE	21+50 / 85R	211.7	TO BE MOVED	NONE

OFA/OFFZ PENETRATIONS								
ID #	DESCRIPTION	STATION/OFFSET	TOP ELEV (MSL)	SURFACE ELEVATION	AMOUNT PENETRATION	OBSTRUCT MARKING	DISPOSITION	STAGE TO CORRECT
A	SUPPLEMENTAL WINDCONE	21+50 / 85R	211.7	188.5	23.2	NONE	RELOCATE	ULTIMATE
B	SEGMENTED CIRCLE	34+57 TO 35+33 / 107L	167 (EST MAX)	163.4 (MAX)	3 (EST MAX)	NONE	RELOCATE	ULTIMATE
C	TREES	VARIES	229 (EST MAX)	193.9	35 (EST MAX)	NONE	REMOVE	ULTIMATE

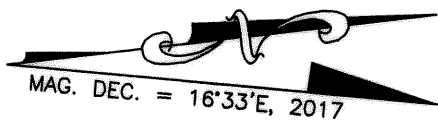

BY	DATE	REVISION

STATE OF ALASKA
DEPARTMENT OF TRANSPORTATION
AND PUBLIC FACILITIES
CENTRAL REGION

HOPE AIRPORT
 HOPE, ALASKA
 AIRPORT LAYOUT PLAN 2016
 EXISTING LAYOUT

DATE: 9/12/2016
 SHEET: 3 OF 7

Date Plotted: 8/18/2017 3:24 PM
 Layout Name: Ultimate Layout
 File Name: W:\Projects\Hope\ALP_Update_2015\Final Drawings\Hope_ALP_2016.dwg
 Designed By: PWC
 Drawn By: PWC
 Checked By: ---

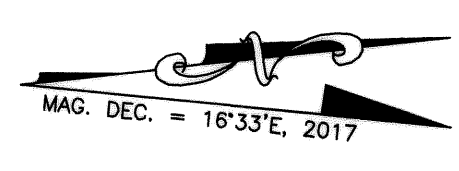
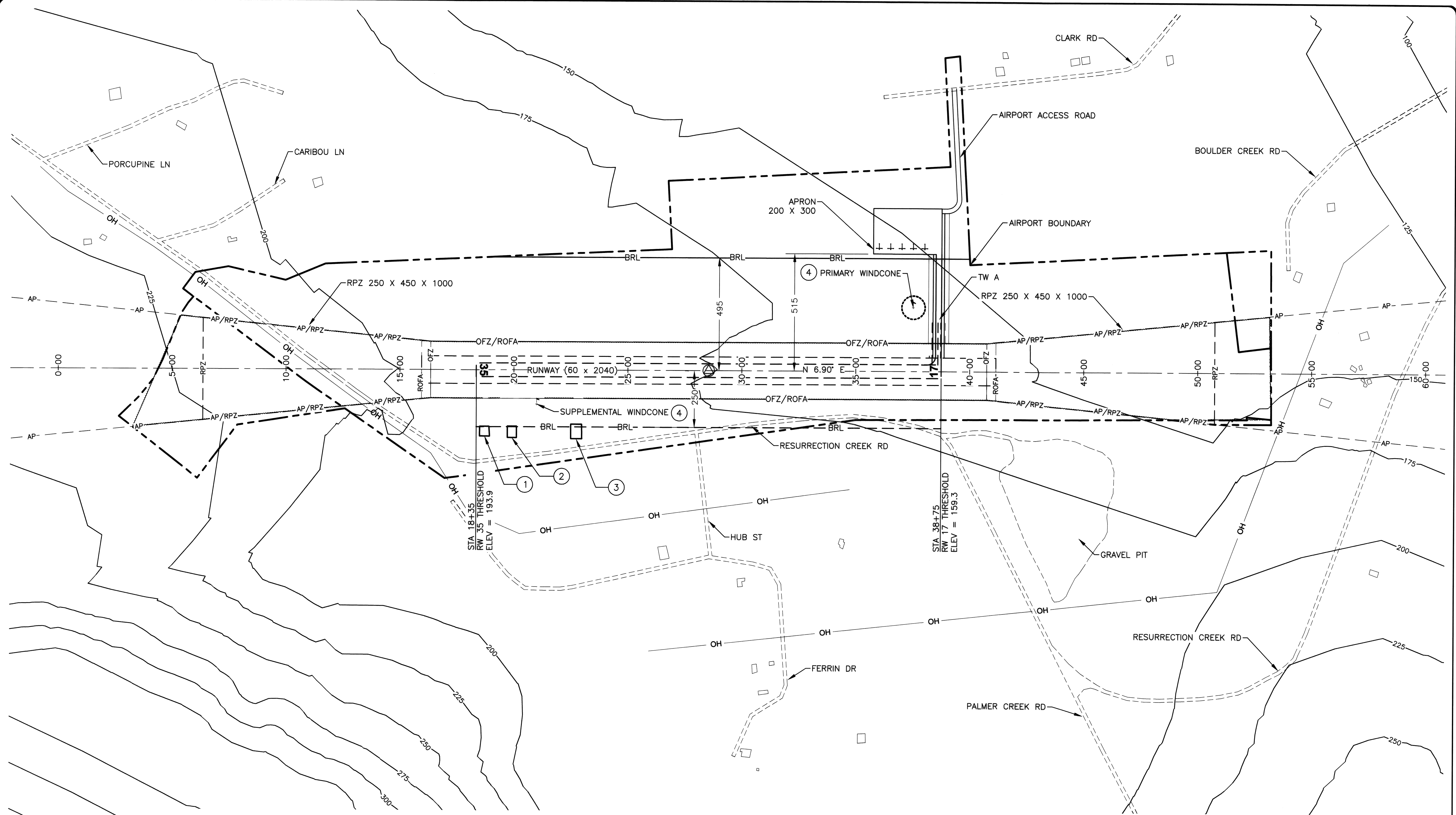

BUILDING DATA					
NO.	DESCRIPTION	STATION/OFFSET	TOP ELEV	STATUS	OBSTRUCTION LIGHT
1	HANGAR	18+71 / 248R	213.7	TO REMAIN	NONE
2	HANGAR	19+92 / 247R	215.2	TO REMAIN	NONE
3	HANGAR	22+74 / 238R	205.7	TO REMAIN	NONE
4	UNLIT PRIM WINDCONE	37+51 / 343L	TBD	ULTIMATE	NONE
5	UNLIT SUP WINDCONE	21+00 / 150R	TBD	ULTIMATE	NONE

NOTE: THERE ARE NO OFZ OR ROFA PENETRATIONS.

BY	DATE	REVISION

STATE OF ALASKA
DEPARTMENT OF TRANSPORTATION
AND PUBLIC FACILITIES
CENTRAL REGION

HOPE AIRPORT
 HOPE, ALASKA
 AIRPORT LAYOUT PLAN 2016

ULTIMATE LAYOUT

DATE:	9/12/2016
SHEET:	4 OF 7

Date Plotted: 9/12/2017, 8:15 AM
 Layout Name: Inner Approach
 File Name: \\utahair03\vol\Projects\Hope\AUP\AUP_2016.dwg
 Designer: PWC
 Drawn By: PWC
 Checked By:

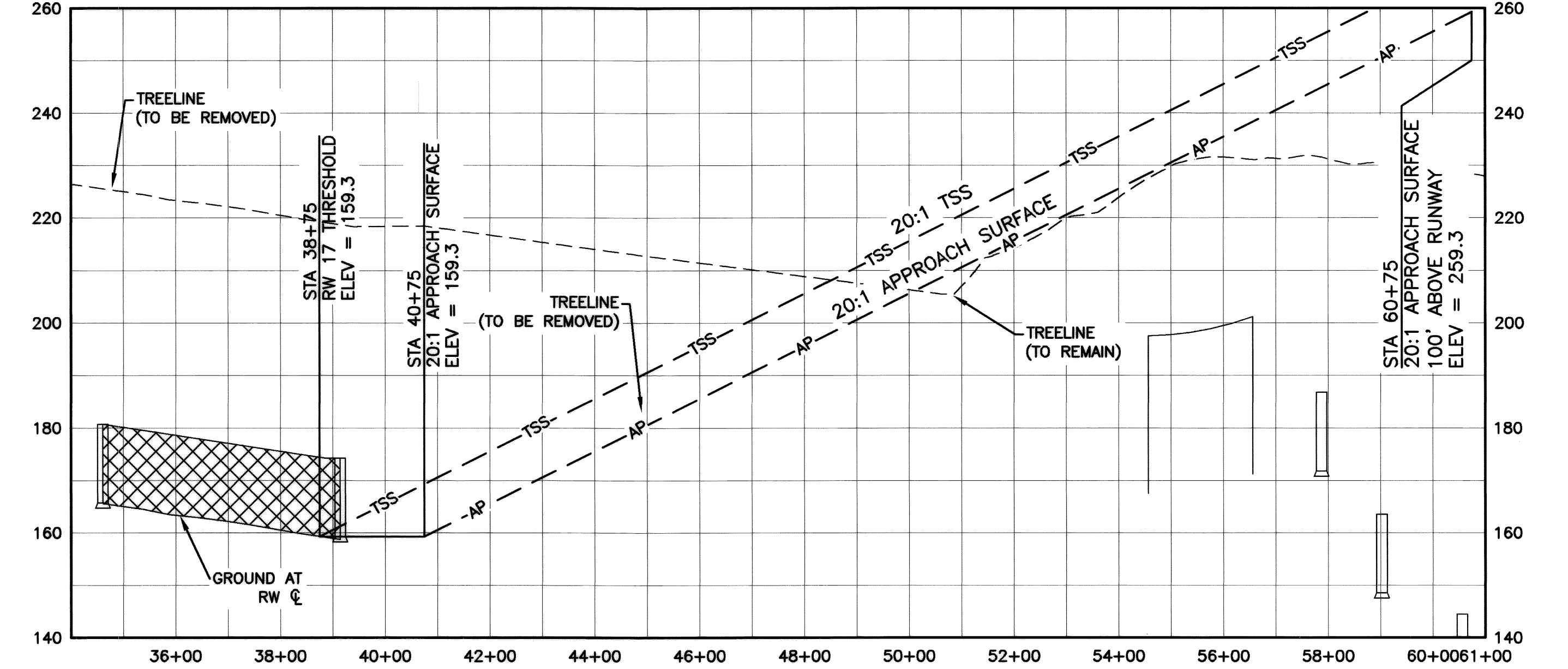
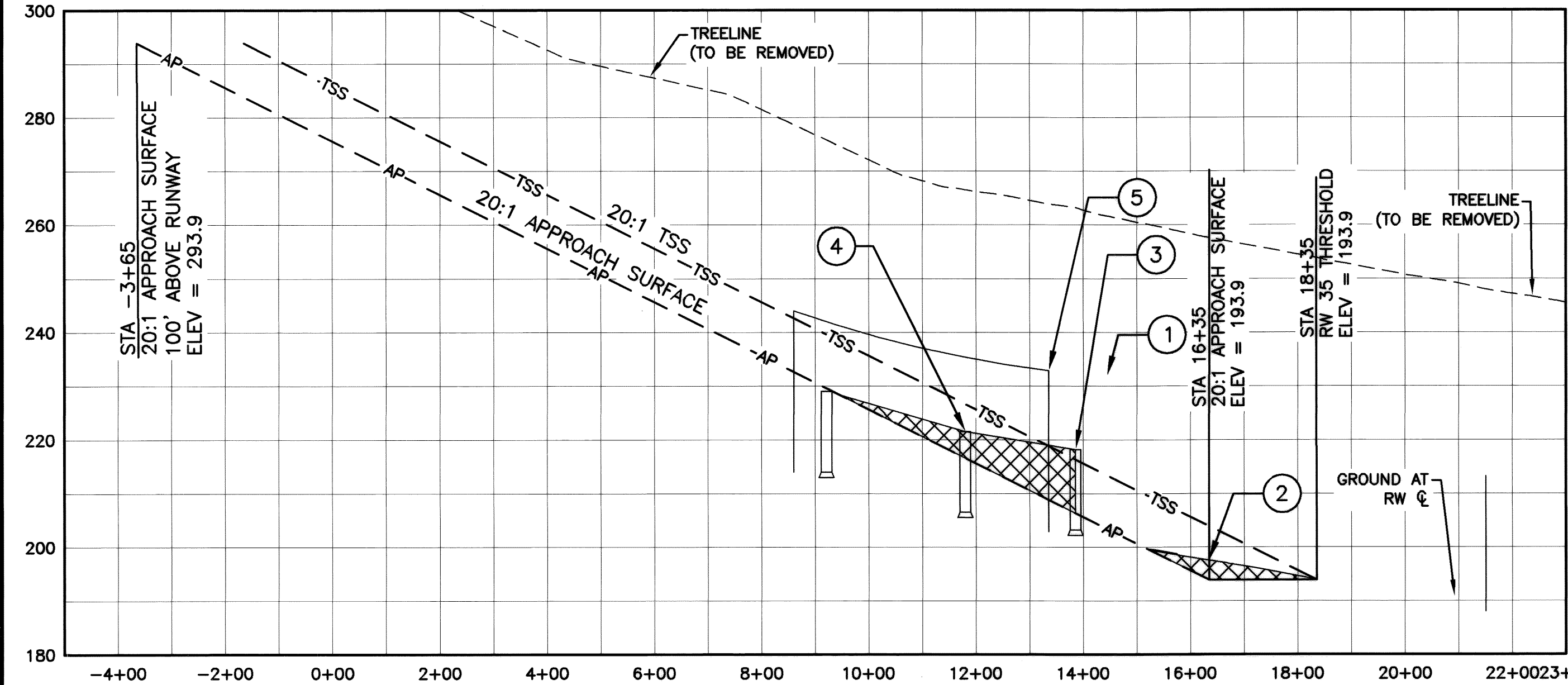
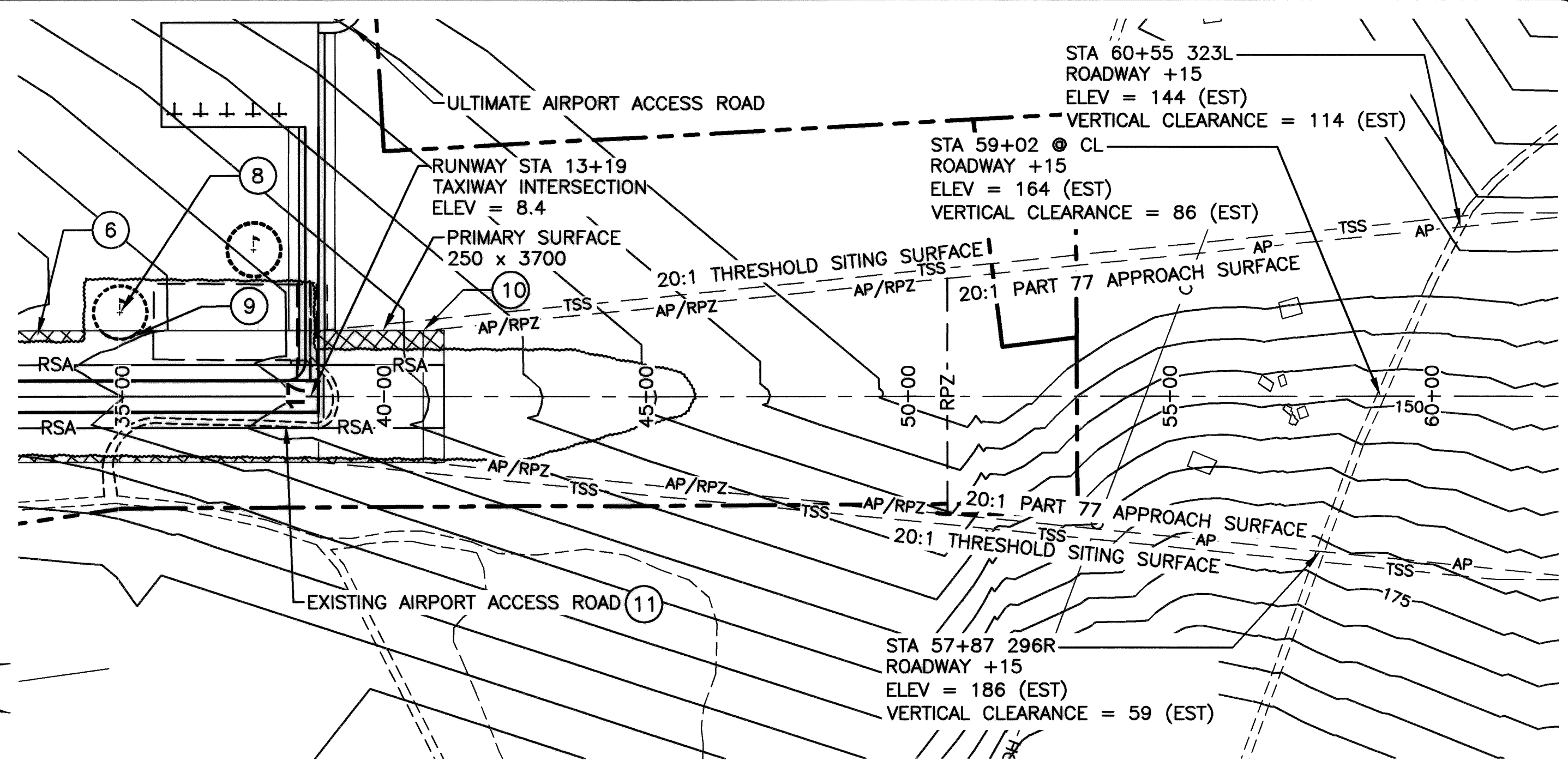
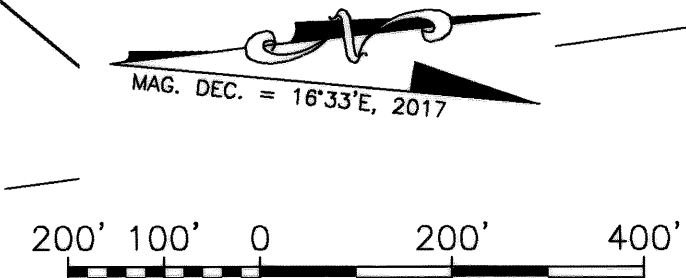
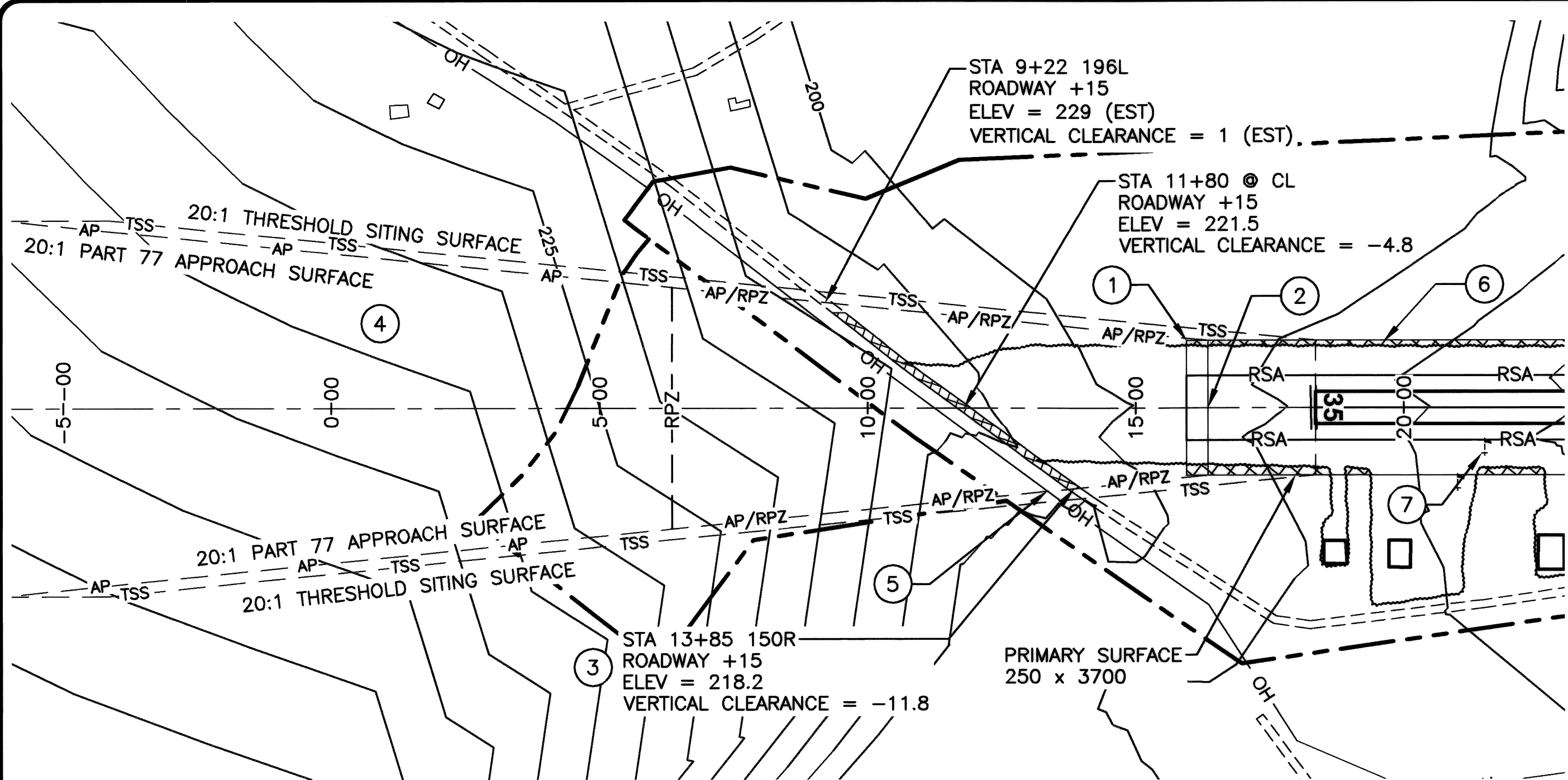

PART 77 SURFACE OBSTRUCTIONS TABLE (INNER PORTION RW 35)

ID #	DESCRIPTION	STATION/OFFSET	GRD ELEV	AGL	TOP ELEV	SURFACE PENETRATED	SURFACE ELEV	AMOUNT PENETRATION	TRIGGER EVENT	DISPOSITION	STAGE TO CORRECT
1	TREES	0+00/16+35/APCH	VARIES	60 (EST)	305 (MAX)	APPROACH/TRANS	VARIES	55 (MAX)	PROJECT	REMOVE	ULTIMATE
2	TERRAIN	18+35/125L-125R	197.6	0.00	197.6	PRIMARY	193.9	3.7	PROJECT	REMOVE	ULTIMATE
3	ROAD (+15)	13+85/150R	203.2	15.0	218.2	APPROACH	206.4	11.8	N/A	TO REMAIN	N/A
4	ROAD (+15)	11+80/@CL	206.5	15.0	221.5	APPROACH	216.6	4.9	N/A	TO REMAIN	N/A
5	POWER LINE	13+36/155L-202R	204 (EST)	30 (EST)	234	APPROACH	208 (MIN)	26 (MAX)	N/A	TO REMAIN	N/A
6	TREES	ALL/90L+ TO 90R+	VARIES	60 (EST)	VARIES	PRIMARY/TRANS	VARIES	60 (MAX)	PROJECT	REMOVE (PRIMARY)	ULTIMATE
7	WIND CONE	21+50/85R	188.5	23.2	211.7	PRIMARY	188.0	23.7	PROJECT	RELOCATE	ULTIMATE

20:1 THRESHOLD SITING SURFACE PENETRATIONS (RW 35)

ID #	DESCRIPTION	STATION/OFFSET	GRD ELEV	AGL	TOP ELEV	SURFACE PENETRATED	SURFACE ELEV	AMOUNT PENETRATION	TRIGGER EVENT	DISPOSITION	STAGE TO CORRECT
1	TREES	5+00/18+35/TSS	VARIES	60 (EST)	290 (MAX)	20:1	VARIES	60 (MAX)	PROJECT	REMOVE	ULTIMATE
3	ROAD (+15)	13+25/14+00/110R	204.4 (MAX)	15.0	219.4 (MAX)	20:1	216.6	1.9 (MAX)	N/A	TO REMAIN	N/A
5	POWER LINE	13+60/173L-225R	204 (EST)	30 (EST)	234	20:1	208 (MIN)	26 (MAX)	N/A	TO REMAIN	N/A

NOTES:
 1. THE CONTROLLING OBSTRUCTION FOR RUNWAY 35 IS A TREE LINE BEGINNING AT THE RW THRESHOLD. THE OBSTRUCTION CLEARANCE SLOPE CANNOT BE CALCULATED.
 2. THRESHOLD SITING CRITERIA IS BASED ON AC 150/5300-13A, TABLE 3-2, LINE 2.

PART 77 SURFACE OBSTRUCTIONS TABLE (INNER PORTION RW 17)

ID #	DESCRIPTION	STATION/OFFSET	GRD ELEV	AGL	TOP ELEV	SURFACE PENETRATED	SURFACE ELEV	AMOUNT PENETRATION	TRIGGER EVENT	DISPOSITION	STAGE TO CORRECT
6	TREES	ALL/90L+ TO 90R+	VARIES	30 (EST)	VARIES	PRIMARY/TRANS	VARIES	30 (MAX)	PROJECT	REMOVE (PRIMARY)	ULTIMATE
8	PRIMARY WINDCONE	34+95/160L	163.2	22.5	185.7	TRANSITIONAL	165.1	20.6	PROJECT	RELOCATE	ULTIMATE
9	SEGMENTED CIRCLE	35+00/109L	163.4	3 (EST)	167	PRIMARY	165.0	7 (MAX)	PROJECT	RELOCATE	ULTIMATE
10	TREES	40+75/45+50/APCH	VARIES	30 (EST)	VARIES	APPROACH/TRANS	VARIES	30 (MAX)	PROJECT	REMOVE (APCH)	ULTIMATE
11	ROAD+15	34+63/39+13/PRIM	166 (MAX)	15.0	181 (MAX)	PRIMARY	159.3 (MIN)	15 (MAX)	PROJECT	RELOCATE	ULTIMATE

20:1 THRESHOLD SITING SURFACE PENETRATIONS (RW 17)

ID #	DESCRIPTION	STATION/OFFSET	GRD ELEV	AGL	TOP ELEV	SURFACE PENETRATED	SURFACE ELEV	AMOUNT PENETRATION	TRIGGER EVENT	DISPOSITION	STAGE TO CORRECT
10	TREES	38+75/43+80/TSS	VARIES	30 (EST)	VARIES	APPROACH/TRANS	VARIES	30 (MAX)	PROJECT	REMOVE (APCH)	ULTIMATE
11	ROAD+15	38+75/39+13/TSS	159.3 (MAX)	15.0	174.3 (MAX)	PRIMARY	159.3 (MIN)	15.0 (MAX)	PROJECT	RELOCATE	ULTIMATE

NOTES:
 1. THE CONTROLLING OBSTRUCTION FOR RUNWAY 17 IS A TREE LINE BEGINNING AT THE RW THRESHOLD. THE OBSTRUCTION CLEARANCE SLOPE CANNOT BE CALCULATED.
 2. THRESHOLD SITING CRITERIA IS BASED ON AC 150/5300-13A, TABLE 3-2, LINE 2.

BY	DATE	REVISION

STATE OF ALASKA
DEPARTMENT OF TRANSPORTATION
AND PUBLIC FACILITIES
CENTRAL REGION
HOPE AIRPORT
HOPE, ALASKA
AIRPORT LAYOUT PLAN 2016
INNER PORTION OF THE
APPROACH SURFACE

DATE: 9/12/2016
 SHEET: 5 OF 7

Date Plotted: 9/12/2016 8:20 AM
 Layout Name: Airspace
 File Name: \\Data\Info3\and\Projects\Hope\ALP\ALP_2016.dwg

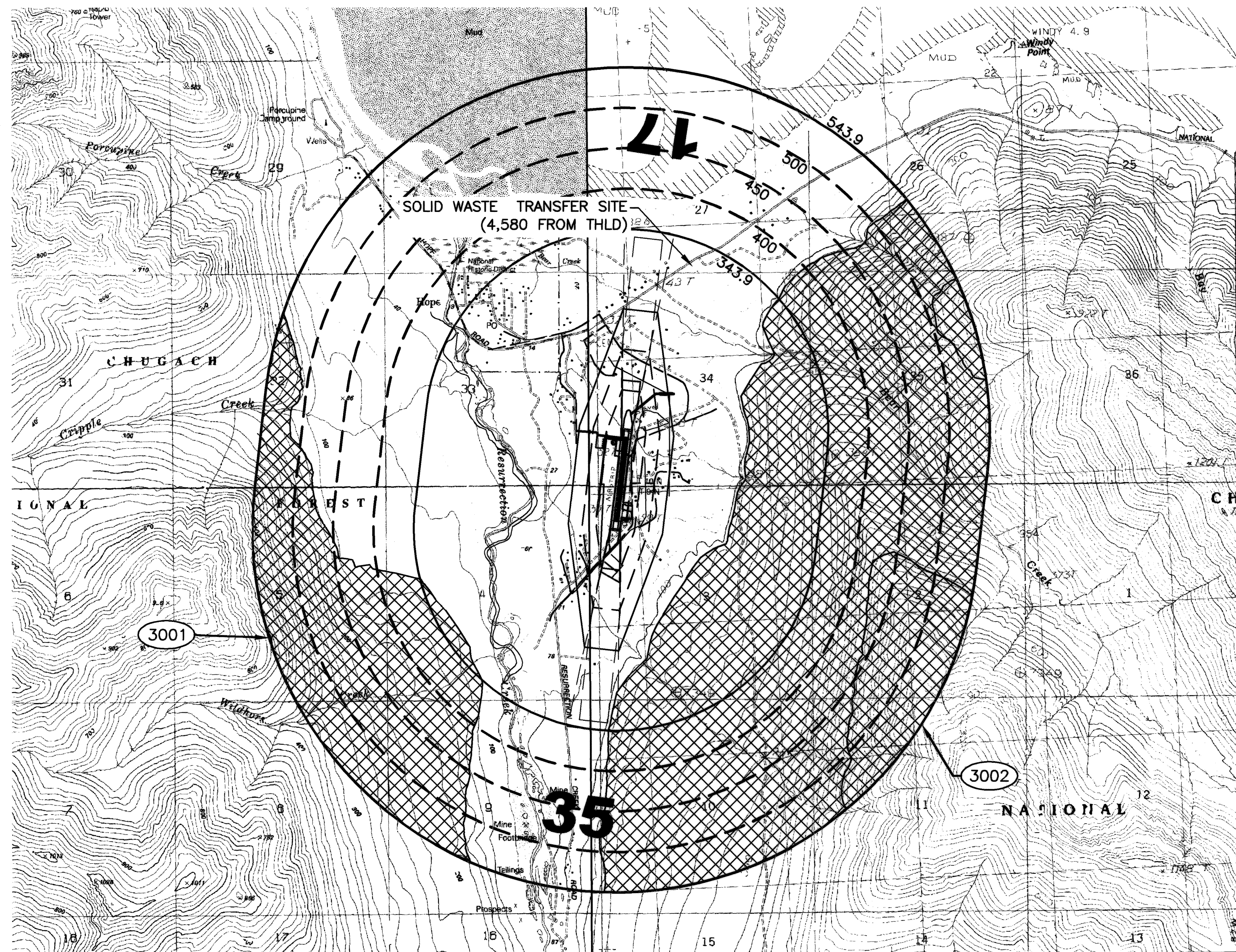

ID #	DESCRIPTION	STATION/OFFSET	ELEVATION	SURFACE PENETRATED	SURFACE ELEVATION	AMOUNT PENETRATION	DISPOSITION	STAGE TO CORRECT
3001	TERRAIN	-20+29/8,219R	1,850	HORZ/CONICAL	544 (MAX)	1,306 (MAX)	TO REMAIN	N/A
3002	TERRAIN	-23+16/8,085L	2,978	HORZ/CONICAL	544 (MAX)	2,434 (MAX)	TO REMAIN	N/A

NOTES:

- ESTABLISHED AIRPORT ELEVATION IS 193.9.
- APPROACH SURFACES ARE 20:1 BEGINNING AT 200' FROM THE THRESHOLDS.
- BASE MAP DATA FROM USGS QUAD, SEWARD, D-7, D-8.
- WIDTH OF PRIMARY SURFACE IS 250'.
- REFER TO THE INNER PORTION OF THE APPROACH SURFACE DRAWINGS FOR CLOSE IN OBSTRUCTIONS.
- THERE ARE NO KNOWN HEIGHT RESTRICTIONS.

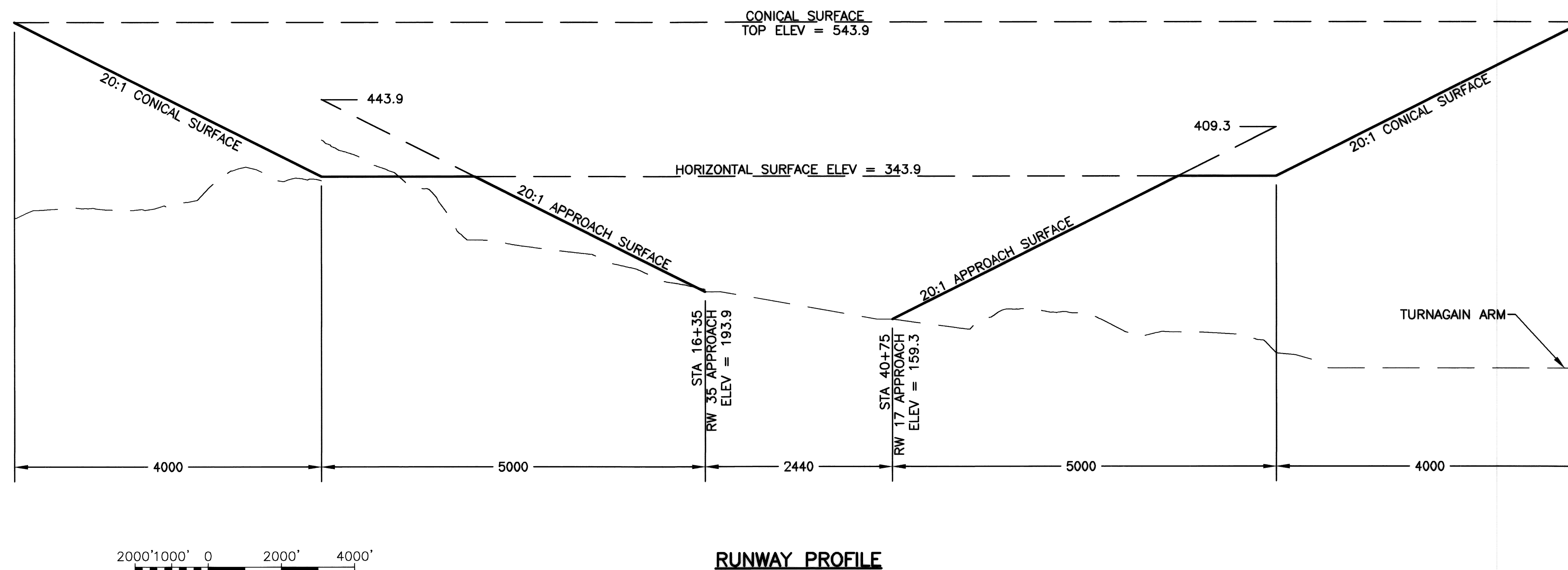

RUNWAY PROFILE

BY DATE REVISION	
STATE OF ALASKA DEPARTMENT OF TRANSPORTATION AND PUBLIC FACILITIES CENTRAL REGION	
HOPE AIRPORT HOPE, ALASKA AIRPORT LAYOUT PLAN 2016	
AIRPORT AIRSPACE, 14 CFR, PART 77	DATE: 9/12/2016 SHEET: 6 OF 7

Date Plotted: 9/12/2017, 8:21 AM
 Layout Name: Property Map
 File Name: \\dotawfs03\gvd\Projects\Hope\ALP\ALP_Update_2015\Final Drawings\Hope_ALP_2016.dwg
 Designed By: PWC
 Drawn By: PWC
 Checked By: ---

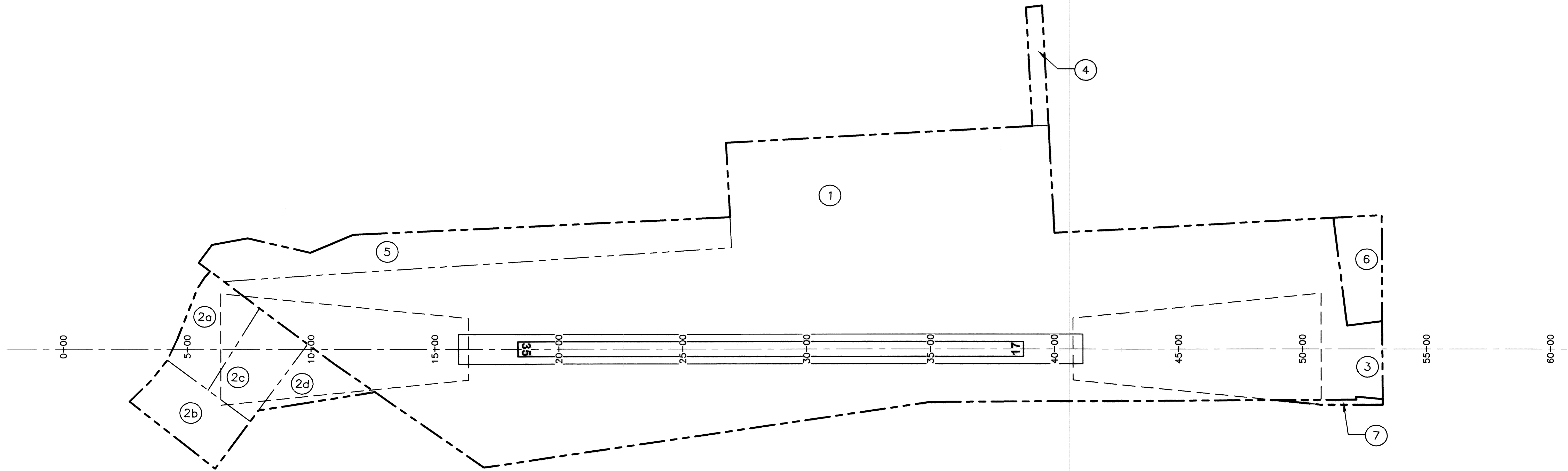

PROPERTY STATUS						
ID #	AREA	GRANTOR	DOT & PF INTEREST	DATE ACQUIRED	RECORDED DOC NO.	ACQUIRED AIP NO.
1	68.19 ac	STATE OF ALASKA, DNR	ILMA	5/14/1998	ADL 222377	
2a	1.40 ac	BIRCH ACRES LLC	FEE SIMPLE	TO BE ACQUIRED	TO BE ACQUIRED	
2b	1.60 ac	BIRCH ACRES LLC	FEE SIMPLE	TO BE ACQUIRED	TO BE ACQUIRED	
2c	1.40 ac	BIRCH ACRES LLC	FEE SIMPLE	TO BE ACQUIRED	TO BE ACQUIRED	
2d	1.27 ac	KING LUCILLE LIVING TRUST	FEE SIMPLE	TO BE ACQUIRED	TO BE ACQUIRED	
3	0.73 ac	STATE OF ALASKA, DNR	ILMA	5/14/1998	ADL 222377	
4	0.61 ac	STATE OF ALASKA, DNR	ILMA	5/14/1998	ADL 222377	
5	5.59 ac	STATE OF ALASKA, DNR	ILMA	5/14/1998	ADL 222377	
6	1.11 ac	APPLEBEE, ROBERT M. REVOCABLE TRUST	FEE SIMPLE	TO BE ACQUIRED	TO BE ACQUIRED	
7	0.17 ac	KENAI PENINSULA BOROUGH	FEE SIMPLE	TO BE ACQUIRED	TO BE ACQUIRED	

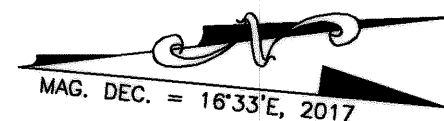

STATE OF ALASKA DEPARTMENT OF TRANSPORTATION AND PUBLIC FACILITIES CENTRAL REGION		
HOPE AIRPORT HOPE, ALASKA AIRPORT LAYOUT PLAN 2016 AIRPORT PROPERTY MAP		DATE: 9/12/2016 SHEET: 7 OF 7
BY	DATE	REVISION