

11/25/2019 9:36 AM

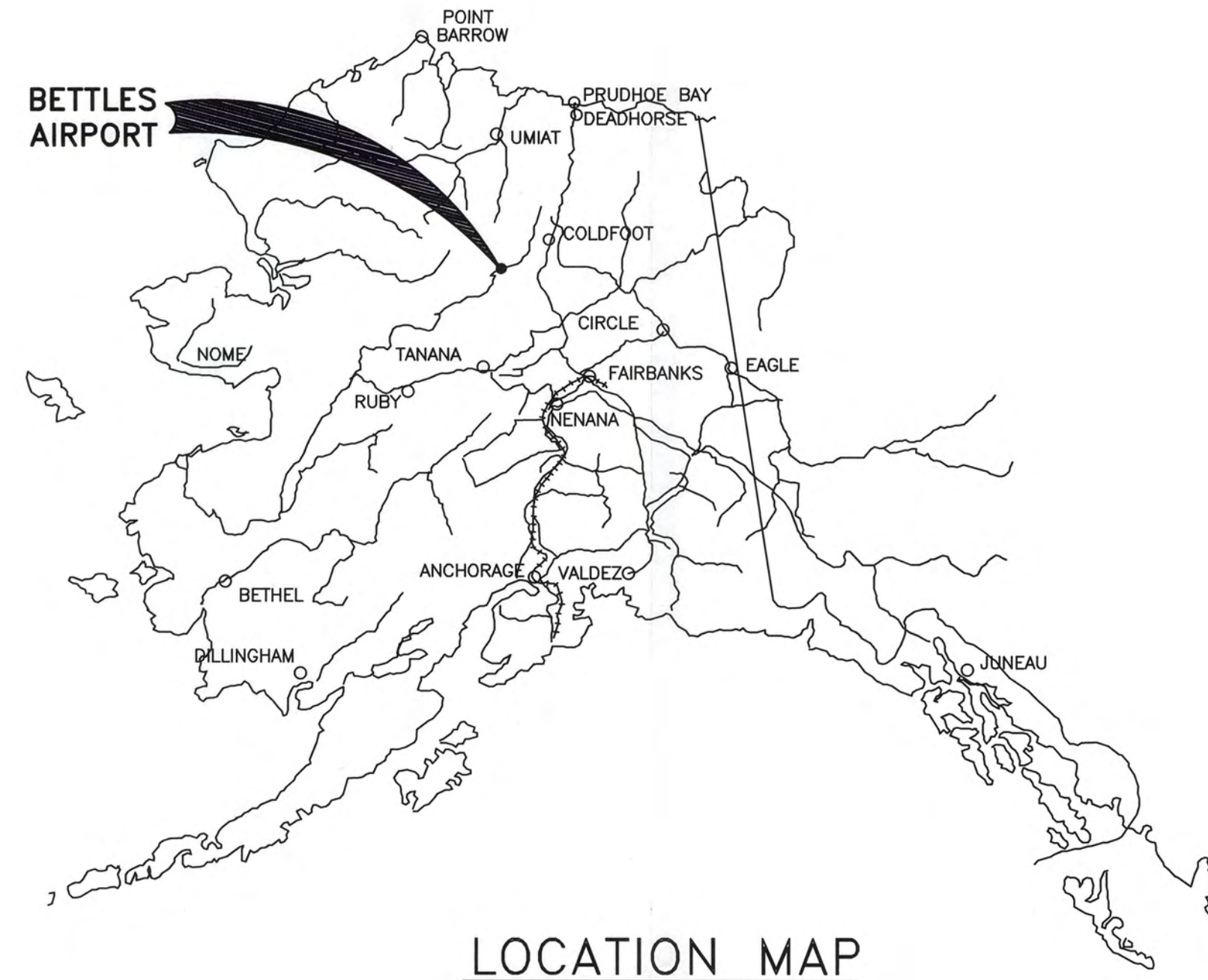

LOCATION MAP

# BETTLES, ALASKA AIRPORT LAYOUT PLAN BETTLES AIRPORT

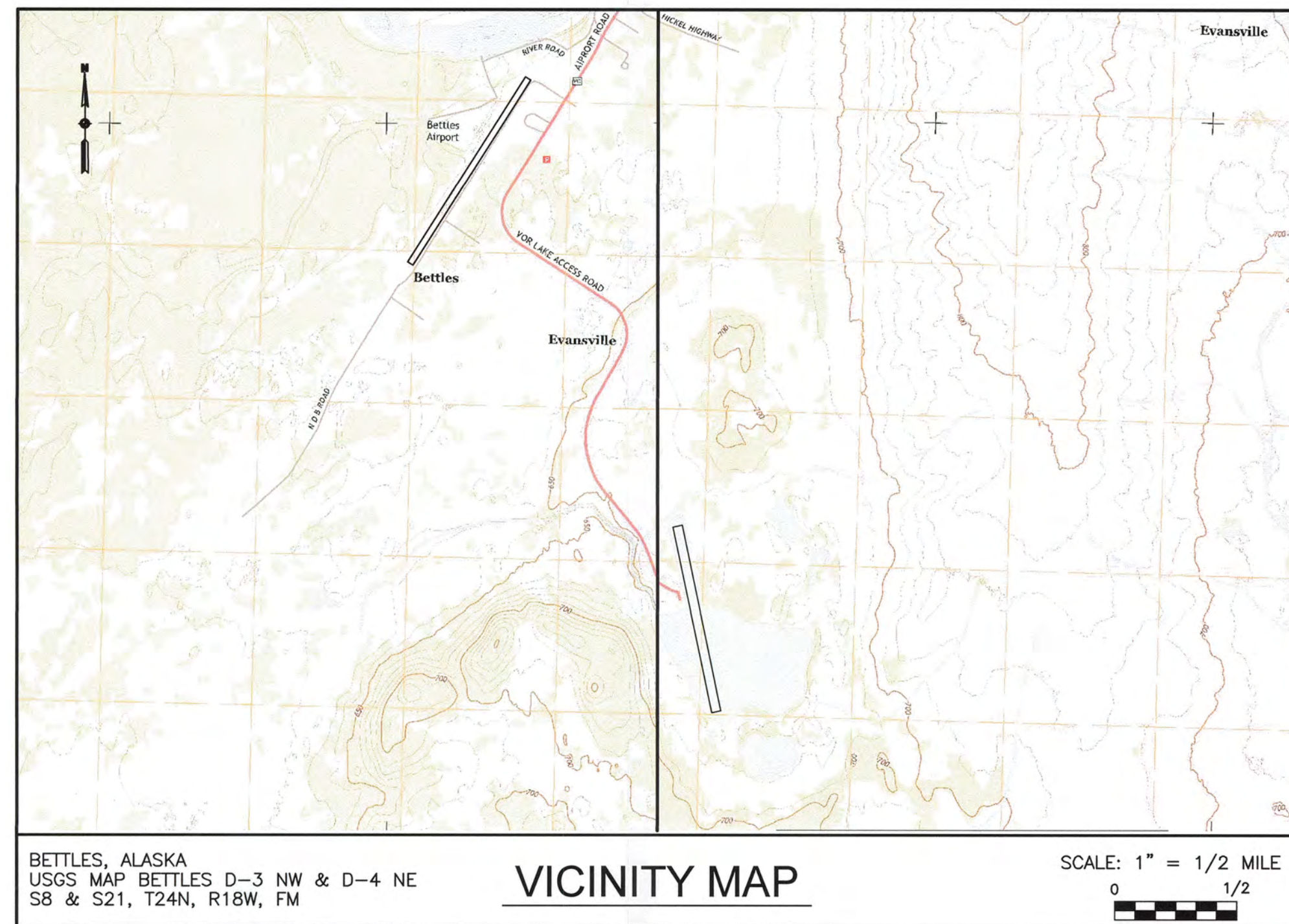

VICINITY MAP

LEGEND		
ITEM	EXISTING	ULTIMATE
AIRPORT REFERENCE POINT		SAME
APPROACH SURFACE		SAME
BUILDING		SAME
BUILDING RESTRICTION LINE		BRL
BUSH		SAME
CENTER LINE		SAME
CONTOUR		SAME
FUEL TANK		SAME
FENCE		SAME
LIGHTING		SAME
PROPERTY LINE		SAME
ROADWAY (GRAVEL)		SAME
ROTATING BEACON		SAME
RUNWAY (GRAVEL)		SAME
RUNWAY OBJECT FREE AREA		OFA
RUNWAY THRESHOLD SITING SURFACE		SAME
RUNWAY OBSTACLE FREE ZONE		OFZ
RUNWAY SAFETY AREA		RSA
RUNWAY SHOULDER		SAME
RUNWAY PROTECTION ZONE		RPZ
SEGMENTED CIRCLE		
SURVEY MONUMENT		SAME
TAXIWAY (GRAVEL)		SAME
TREE		SAME
VASI		SAME
WATERBODY		SAME
WIND CONE		

SHEET INDEX	
SHEET NO.	DESCRIPTION
1	COVER
2	AIRPORT DATA
3	EXISTING AIRPORT LAYOUT PLAN
4	ULTIMATE AIRPORT LAYOUT PLAN
5	EXISTING/ULTIMATE AIRPORT LAYOUT PLAN (VOR LAKE WATERLANE)
6	EXISTING/INTERIM/ULTIMATE TERMINAL PLAN
7	EXISTING INNER PORTION OF APPROACH SURFACE (R/W 2/20)
8	ULTIMATE INNER PORTION OF APPROACH SURFACE (R/W 2/20)
9	AIRPORT AIRSPACE (FAR PART 77)
10	AIRPORT AIRSPACE PROFILES (FAR PART 77)
11	AIRPORT PROPERTY MAP
12	AIRPORT LAND USE

H:\info\_communities\bettles\02 alp file\2019 final alp\cod files\00419BTT\_ALP01-ALP01

DESIGN MMM  
DRAWN RWW  
CHECKED CFJ

STATE OF ALASKA  
DEPARTMENT OF TRANSPORTATION AND PUBLIC FACILITIES  
NORTHERN REGION-AVIATION

APPROVED:  
Albert M.L. Beck DATE 11/13/2020  
ALBERT M.L. BECK, P.E. PROJECT DELIVERY LEAD

AIRPORT LAYOUT PLAN CONDITIONAL APPROVAL SUBJECT TO  
ALP APPROVAL LETTER DATED 2/11/2020  
FAA AIRSPACE REVIEW NUMBER: 2018-AAL-356-NKA

Kate Hoo DATE 2-11-2020  
FAA, AIRPORTS DIVISION ALASKAN REGION, AAL- 612

BY	DATE	REVISIONS

BETTLES AIRPORT  
BETTLES, ALASKA  
COVER

SHEET  
1  
OF  
12



WIND DATA (ALL WEATHER)				
RUNWAY	20 kt (C-IV)	16 kt (B-III)	13 kt (B-II)	10.5 kt (A-I)
2/20	100.0%	99.99%	99.92%	99.84%
14W/32W	N/A	N/A	N/A	99.16%

SOURCE: NCDC ISH/ISD  
STATION NAME: BETTLES  
PERIOD: 2010-2019

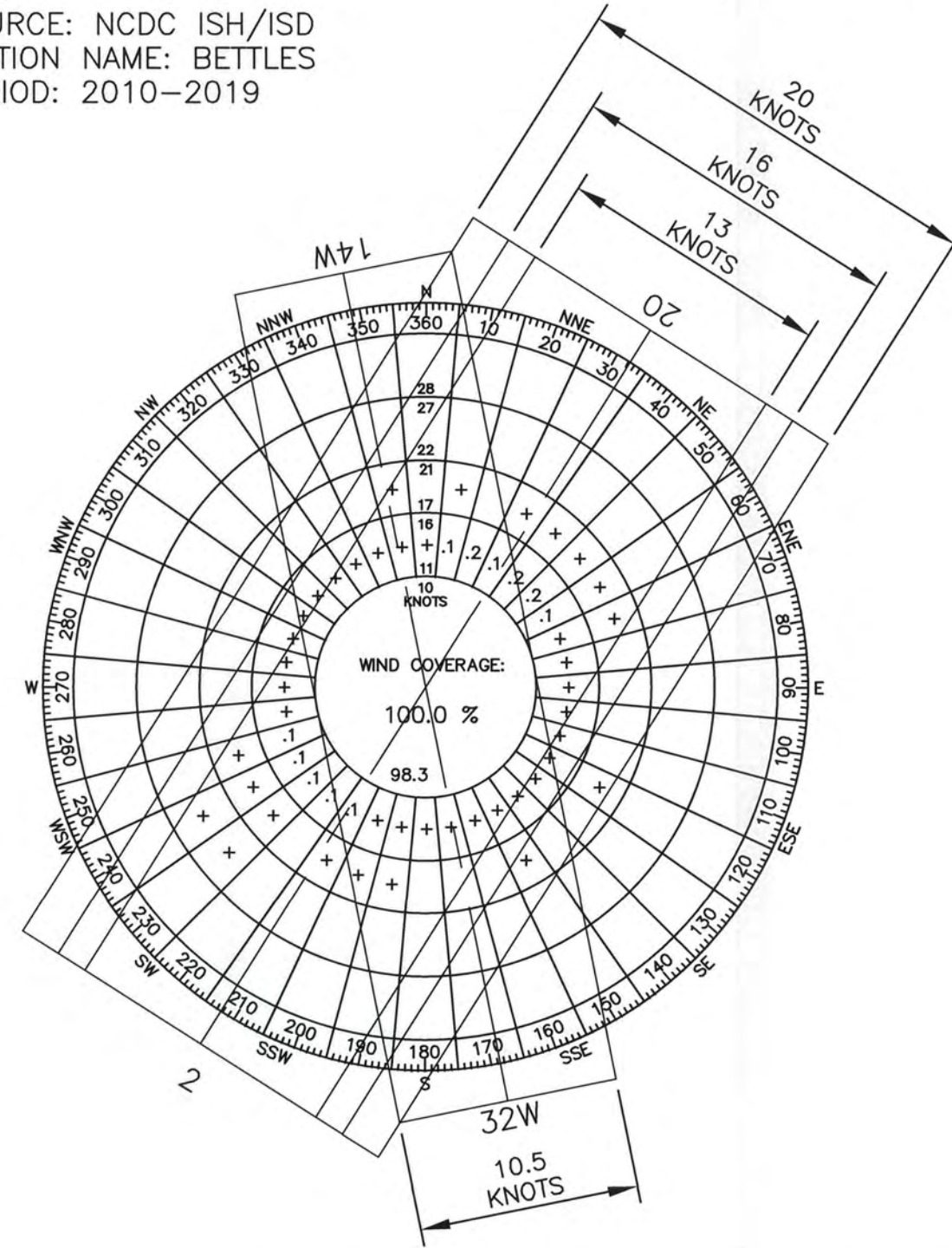

WIND DATA (IFR)				
RUNWAY	20 kt (C-IV)	16 kt (B-III)	13 kt (B-II)	10.5 kt (A-I)
2/20	100.0%	99.99%	99.94%	99.83%
14W/32W	N/A	N/A	N/A	N/A

SOURCE: NCDC ISH/ISD  
STATION NAME: BETTLES  
PERIOD: 2010-2019

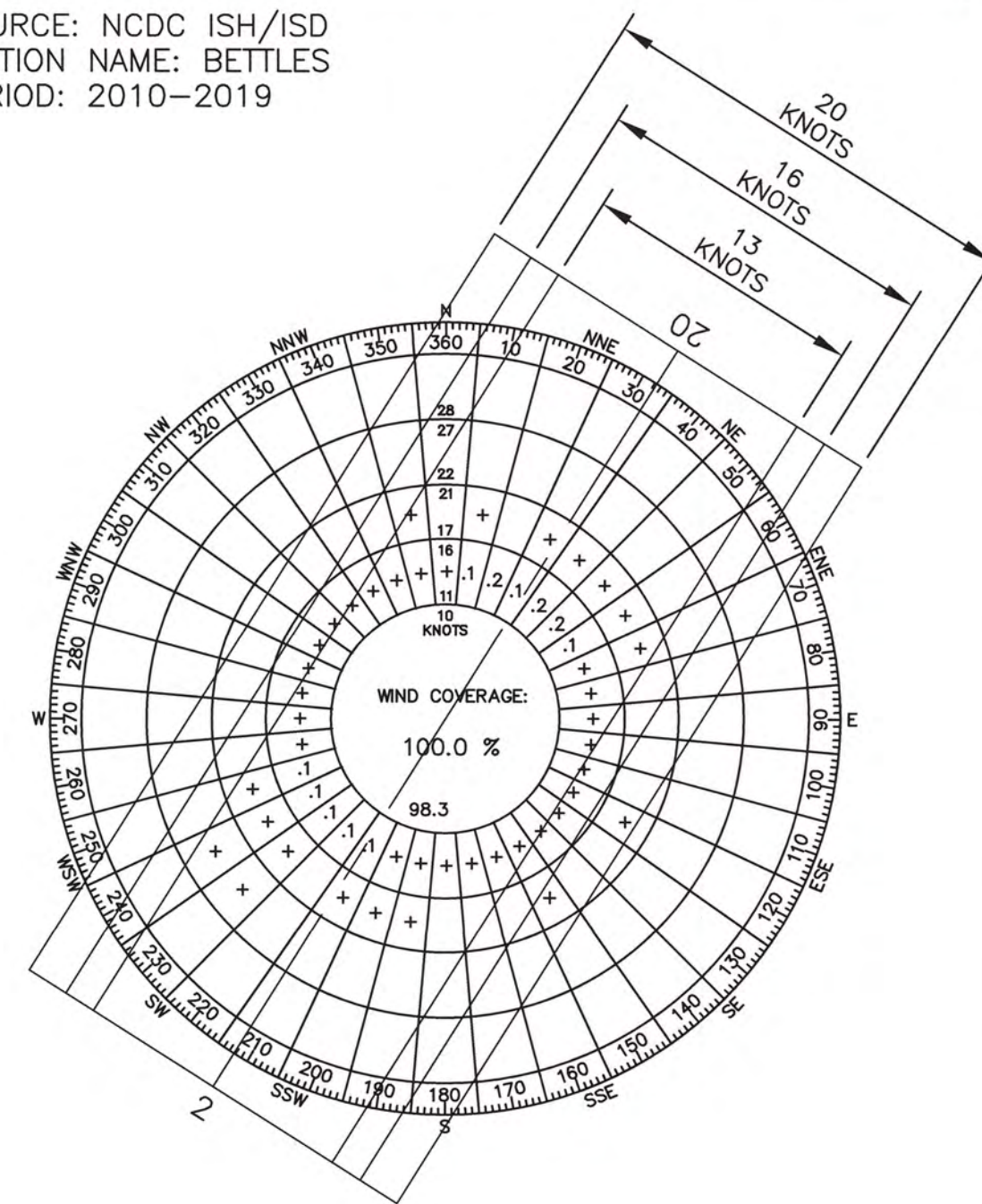

### GEOGRAPHIC COORDINATES (NAD 83) & ELEVATIONS (NAVD 88)

ITEM	EXISTING LATITUDE	EXISTING LONGITUDE	EXISTING ELEVATION	ULTIMATE LATITUDE	ULTIMATE LONGITUDE	ULTIMATE ELEVATION
AIRPORT REFERENCE POINT	66°54'50.18" N	151°31'44.56" W	N/A	SAME	SAME	SAME
RW 2 END	66°54'28.59" N	151°32'19.30" W	634.95'	SAME	SAME	SAME
RW 20 END	66°55'11.77" N	151°31'09.83" W	646.31'	SAME	SAME	SAME
RW 14W END	66°53'34.57" N	151°29'49.13" W	649.39'	SAME	SAME	SAME
RW 32W END	66°52'55.03" N	151°29'28.74" W	649.39'	SAME	SAME	SAME

### PACS & SACS

DESIGNATION	LATITUDE	LONGITUDE	ELLIPSOID HEIGHT	NORTHING	EASTING	ELEVATION	DESCRIPTION
BTT A	66°54'51.04" N	151°31'47.29" W	662.42'	4722907.88'	1420755.71'	638.39'	PACS
BTT B	66°54'29.36" N	151°32'22.82" W	657.00'	4720740.16'	1419284.60'	633.01'	SACS
BTT E	66°55'04.83" N	151°31'17.04" W	668.42'	4724279.61'	1421996.53'	644.38'	SACS

### DECLARED DISTANCES

RUNWAY	TORA		TODA		ASDA		LDA	
	EXISTING	ULTIMATE	EXISTING	ULTIMATE	EXISTING	ULTIMATE	EXISTING	ULTIMATE
RW 2	5190'	5190'	5190'	5190'	5190'	5190'	5190'	5190'
RW 20	5190'	5190'	5190'	5190'	5190'	5190'	5190'	5190'

#### NOTES:

- THIS DRAWING IS MERELY A COMPILATION OF SELECTED MAPPING DATA. IT IS NOT A COMPLETE SURVEY OF ANY KIND.
- THE COORDINATE SYSTEM USED FOR THIS SURVEY IS NAD83 (2011) ALASKA STATE PLANE ZONE 4 IN U.S. SURVEY FEET.
- THE VERTICAL DATUM IS NAVD 88 USING GEOID12A.
- SURVEY FIELDWORK WAS COMPLETED AND AERIAL PHOTOGRAPHY WAS FLOWN IN AUGUST 2014.

### AIRPORT DATA

ITEM	EXISTING	ULTIMATE
ICAO IDENTIFIER	PABT	SAME
NATIONAL AIRPORT IDENTIFIER	BTT	SAME
FAA SITE NUMBER	50062.*A	SAME
AIRPORT REFERENCE CODE (ARC)	A-II SMALL	B-II SMALL
NPIAS SERVICE LEVEL (P, CS, R, GA)	GA	SAME
AASP CLASSIFICATION	LOWER ACTIVITY	SAME
AIRPORT ELEVATION (NAVD88)	647.28'	SAME
MEAN MAX. TEMPERATURE, HOTTEST MONTH	69°F, JULY	SAME
OBSTRUCTION SURVEY SOURCE & TYPE	AOC (SEE NOTES)	SAME
MAGNETIC DECLINATION, YEAR, RATE OF CHANGE	15°31' E, 2020, 0°27' W / YEAR	SAME
AIRPORT AND TERMINAL NAVIGATION AIDS	ROT. BEACON, WINDCONE, SEG. CIR., NDB, VOR, DME, ASOS	SAME

### RUNWAY DATA

ITEM	RUNWAY 2/20		RUNWAY 14W/32W (VOR LAKE)	
	EXISTING	ULTIMATE	EXISTING	ULTIMATE
FAR PART 77 APPROACH CATEGORY (UTILITY, OTHER THAN UTILITY)	OTHER THAN UTILITY	SAME	N/A	SAME
FAR PART 77 APPROACH TYPE (V, C, NPA, PA)	NPA	NPA/NPA	N/A	SAME
AERONAUTICAL SURVEY TYPE	VERTICALLY GUIDED	SAME	VERTICALLY GUIDED	SAME
RUNWAY DESIGN CODE (RDC)	A-II-5000	B-II-5000	A-I-VIS	SAME
RUNWAY REFERENCE CODE (RRC)	A-II-5000	B-II-5000	A-I-VIS	SAME
CRITICAL AIRCRAFT	C-208	C-208 / PA-31	DHC-2	SAME
FAR PART 77 APPROACH SLOPE	34:1	34:1 / 34:1	N/A	SAME
THRESHOLD SITING SURFACE	20:1	20:1 / 20:1	N/A	SAME
VISIBILITY MINIMUM	≥1 SM	≥1 SM / ≥1 SM	VIS / VIS	SAME
RUNWAY SURFACE	GRAVEL	SAME	WATER	SAME
PAVEMENT STRENGTH (SW,DW,DTW x1000lbs)	N/A	SAME	N/A	SAME
TRUE MEAN BEARING	N 32°16'08" E	SAME	S 11°27'24" E	SAME
MAXIMUM ELEVATION ABOVE MSL	647.28'	SAME	649.39'	SAME
EFFECTIVE GRADE	0.23%	SAME	N/A	SAME
RUNWAY TOUCHDOWN ZONE ELEVATIONS (NAVD 88)	RW 2: 642.4'	SAME	RW 14W: 649.4'	SAME
	RW 20: 647.3'	SAME	RW 32W: 649.4'	SAME
RUNWAY DIMENSIONS	150' x 5190'	75' x 5190'	200' x 4100'	SAME
RUNWAY SAFETY AREA (RSA) DIMENSIONS	150' x 5790'	SAME	N/A	SAME
RSA LENGTH BEYOND RW ENDS	300'	SAME	N/A	SAME
RUNWAY PROTECTION ZONE (RPZ) DIMENSIONS	250' x 450' x 1000'	SAME	N/A	SAME
RUNWAY OBJECT FREE AREA (OFA) DIMENSIONS	500' x 5790'	SAME	N/A	SAME
ROFA LENGTH BEYOND RW ENDS	300'	SAME	N/A	SAME
RUNWAY OBSTACLE FREE ZONE (OFZ) DIMENSIONS	250' x 5590'	SAME	N/A	SAME
PRECISION OBJECT FREE ZONE (POFZ) DIMENSIONS	N/A	SAME	N/A	SAME
RUNWAY LIGHTING TYPE	MIRL	SAME	NONE	SAME
RUNWAY MARKING TYPE (P, NP, NONE)	NONE	SAME	NONE	SAME
RUNWAY VISUAL APPROACH AIDS	MALSR, VASI	MALSR, PAPI	NONE	SAME
RUNWAY LANDING AIDS	VOR/DME, RNAV(GPS)	SAME	NONE	SAME

### NON-STANDARD CONDITIONS

ITEM	STANDARD	EXISTING	ULTIMATE
RUNWAY 2/20 WIDTH	75'	150'	75'
TAXIWAY WIDTH	35' ( II / 2)	85'	35'
RSA ON RUNWAY 20 END LONGITUDINAL GRADE	MAXIMUM 3%	>3%	3%
BUILDINGS WITHIN BRL	NONE	20'+	NONE

#### NOTES:

- SEE AIRPORT LAYOUT PLANS FOR TAXIWAY DATA.
- VOR LAKE AIRPORT ELEVATION IS ESTABLISHED AS THE MEAN WATER SURFACE ELEVATION AT THE TIME OF THE GROUND SURVEY.

H:\info\_communities\bettles\02 alp file\2019 final alp\cad files\00419BTT\_ALP02-ALP02

DESIGN MMM  
DRAWN RWW  
CHECKED CFJ

STATE OF ALASKA  
DEPARTMENT OF TRANSPORTATION AND PUBLIC FACILITIES  
NORTHERN REGION-AVIATION  
APPROVED: Albert M.L. Beck DATE 1/15/2020  
ALBERT M.L. BECK, P.E. PROJECT DELIVERY LEAD

BY	DATE	REVISIONS	FAA

BY	DATE	REVISIONS	FAA

BETTLES AIRPORT  
BETTLES, ALASKA  
AIRPORT DATA

SHEET  
2 OF  
12



H:\info\_communities\bettes\02\_dip\_file\2019\_final\_dip\_files\00419BTT\_ALP03-ALP03

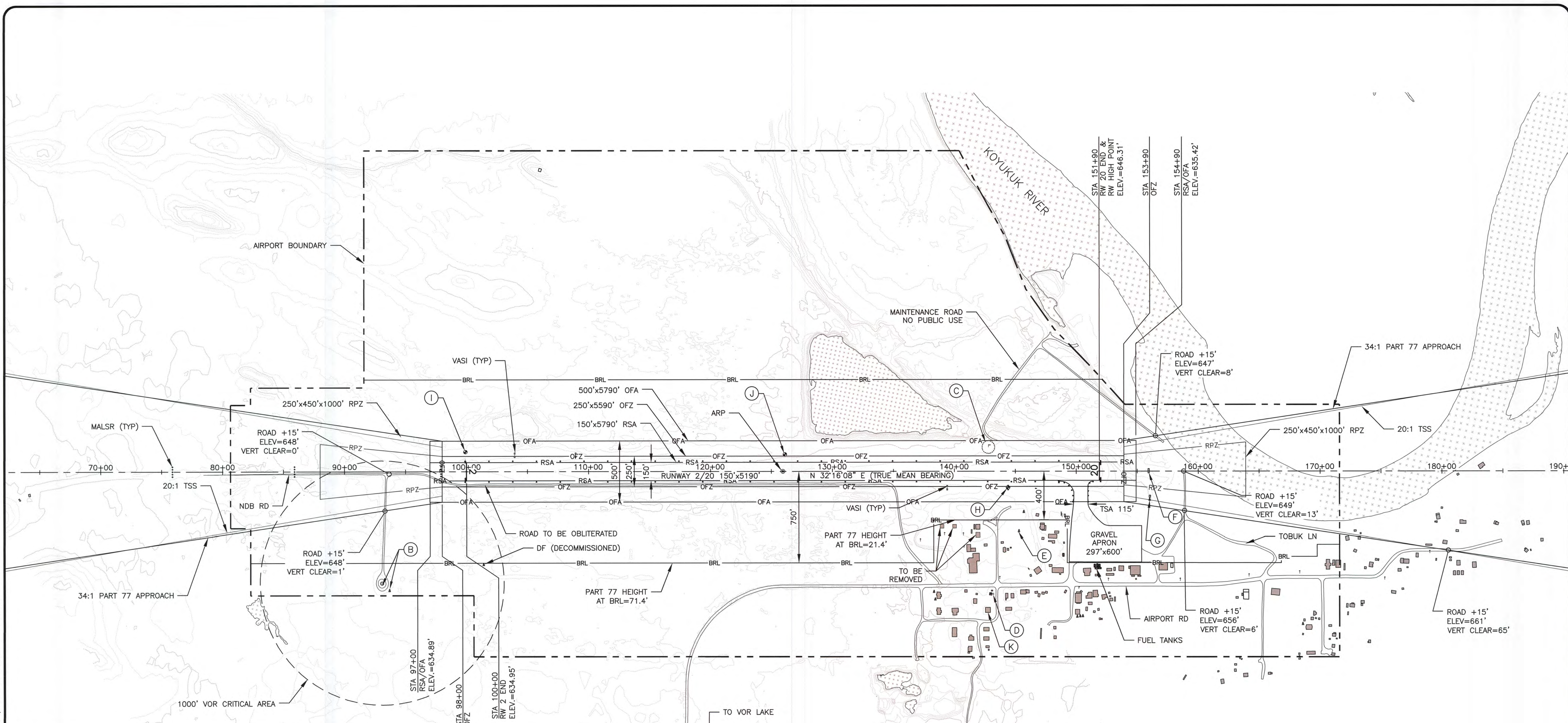

BUILDINGS/FACILITIES			
BLD/FAC	DESCRIPTION	STATION/OFFSET	TOP ELEV.
(A)	NDB TOWER (NOT SHOWN)	STA 35+13/162' LT	763.9'
(B)	VOR/DME	STA 93+08/915' RT	673.6'
(C)	LIGHTED WIND CONE & SEGMENTED CIRCLE	STA 142+79/198' LT	665.8'
(D)	ROTATING BEACON	STA 143+05/1004' RT	685.0'
(E)	ASOS	STA 145+29/500' RT	678.6'
(F)	LOCALIZER (DECOMMISSIONED)	STA 156+19/0.0' RT	642.6'
(G)	DME (DECOMMISSIONED)	STA 156+02/240' RT	655.2'
(H)	PACS BTT 'A'	STA 126+11/138' LT	638.4'
(I)	SACS BTT 'B'	STA 99+91/161' LT	633.0'
(J)	SACS BTT 'E'	STA 144+40/134' RT	644.4'
(K)	SREB	STA 142+73/1135' RT	673.2'

- NOTES:**
- RUNWAY 2 IS TURF FOR FIRST 1200'.
  - RUNWAY 2/20 HAS OFZ PENETRATIONS CONSISTING OF TREES AND BUSHES.

TAXIWAY DATA	
ITEM	EXISTING
TAXIWAY DESIGN GROUP (ADG / TDG)	II / 2
TAXIWAY DIMENSIONS	85' x 447'
TAXIWAY SHOULDER WIDTH	15'
TAXIWAY EDGE SAFETY MARGIN (TESM)	7.5'
TAXIWAY SAFETY AREA (TSA) WIDTH	115'
TAXIWAY OBJECT FREE AREA (TOFA) WIDTH	UNDEFINED
TAXIWAY LIGHTING	MITL

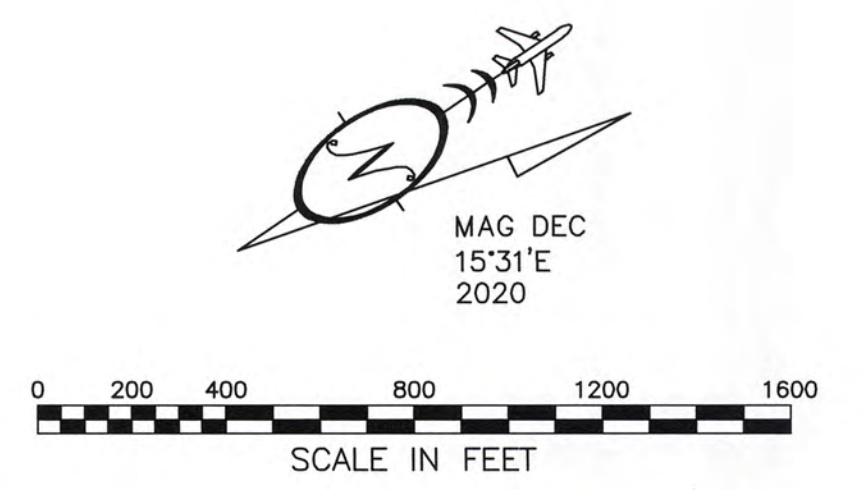

DESIGN MMM  
 DRAWN RWW  
 CHECKED CFJ

STATE OF ALASKA  
 DEPARTMENT OF TRANSPORTATION AND PUBLIC FACILITIES  
 NORTHERN REGION-AVIATION

APPROVED: *Albert M.L. Beck* DATE 1/13/2020  
 ALBERT M.L. BECK, P.E. PROJECT DELIVERY LEAD

BY	DATE	REVISIONS	FAA

BY	DATE	REVISIONS	FAA

BETTLES AIRPORT  
 BETTLES, ALASKA  
 EXISTING AIRPORT LAYOUT PLAN

SHEET  
3 OF  
 12



H:\info\_communities\bettes\02 alp file\2019 final alp files\00419BTT\_ALP04-ALP04

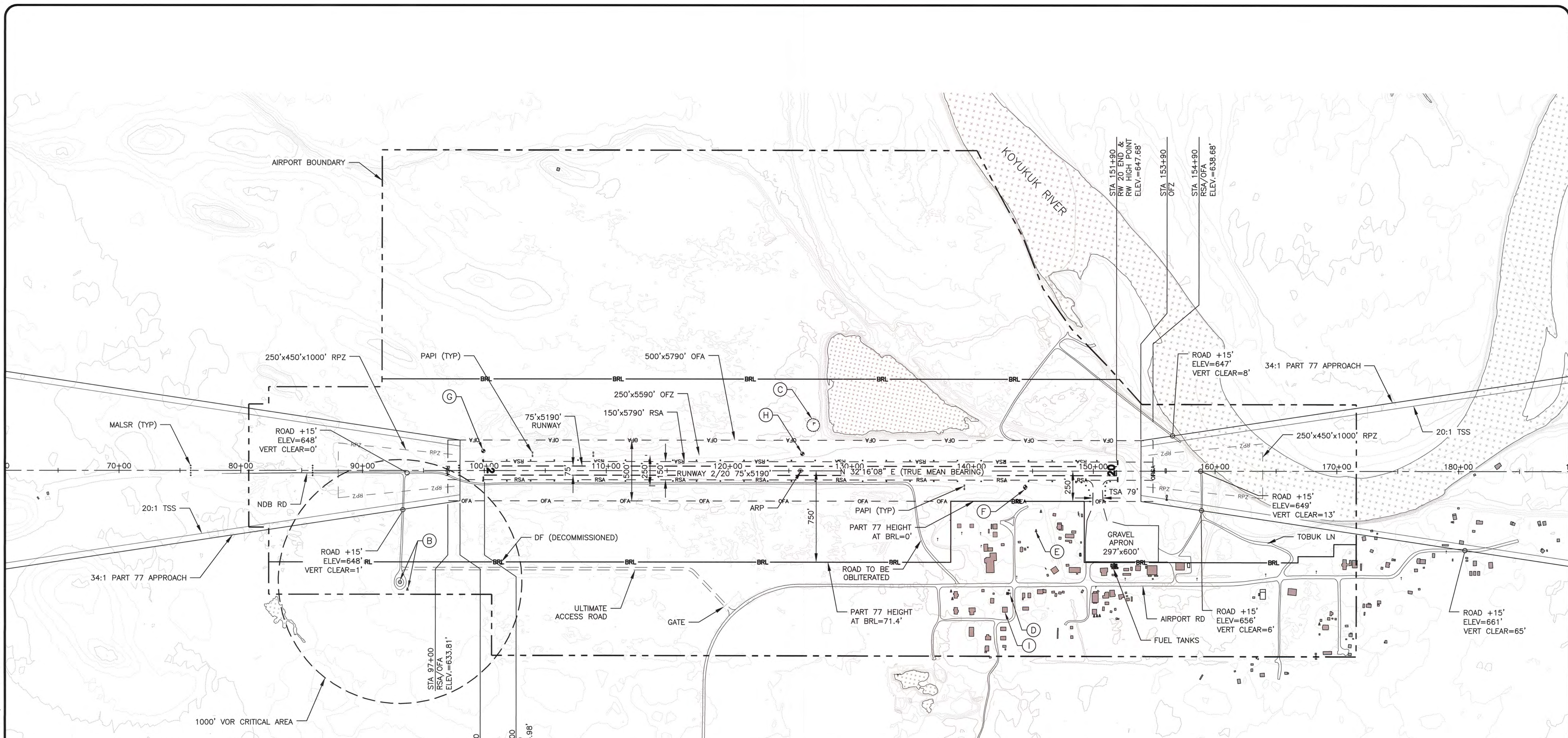

BUILDINGS/FACILITIES			
BLD/FAC	DESCRIPTION	STATION/OFFSET	TOP ELEV.
(A)	NDB TOWER (NOT SHOWN)	STA 35+13/162' LT	763.9'
(B)	VOR/DME	STA 93+08/915' RT	673.6'
(C)	ULTIMATE LIGHTED WIND CONE & SEGMENTED CIRCLE	STA 127+00/375' LT	641.0'
(D)	ROTATING BEACON	STA 143+05/1004' RT	685.0'
(E)	ASOS	STA 145+29/500' RT	678.6'
(F)	PACS BTT 'A'	STA 126+11/138' LT	638.4'
(G)	SACS BTT 'B'	STA 99+91/161' LT	633.0'
(H)	SACS BTT 'E'	STA 144+40/134' RT	644.4'
(I)	SREB	STA 142+73/1135' RT	673.2'

**NOTES:**  
 1. RUNWAY 2 IS TURF FOR FIRST 1200'.  
 2. RUNWAY 2/20 HAS OFZ PENETRATIONS CONSISTING OF TREES AND BUSHES.

TAXIWAY DATA	
ITEM	ULTIMATE
TAXIWAY DESIGN GROUP (ADG / TDG)	II / 2
TAXIWAY DIMENSIONS	35' x 447'
TAXIWAY SHOULDER WIDTH	15'
TAXIWAY EDGE SAFETY MARGIN (TESM)	7.5'
TAXIWAY SAFETY AREA (TSA) WIDTH	79'
TAXIWAY OBJECT FREE AREA (TOFA) WIDTH	131'
TAXIWAY LIGHTING	MITL

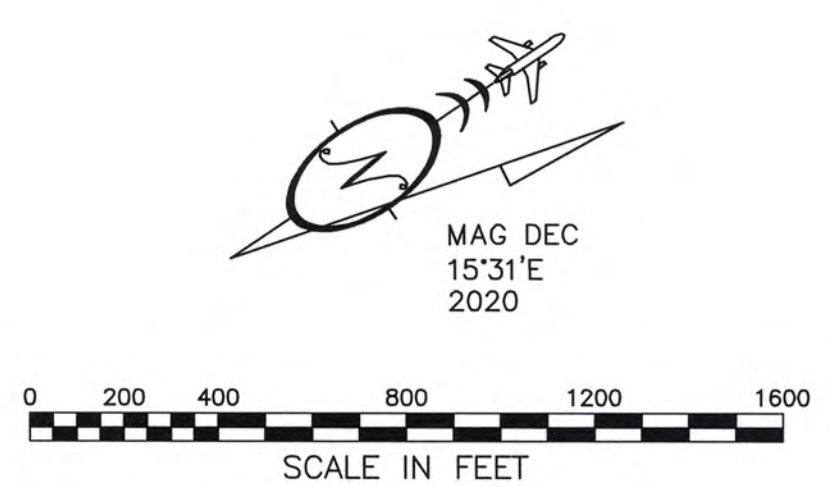

DESIGN MMM  
 DRAWN RWW  
 CHECKED CFJ

**STATE OF ALASKA**  
 DEPARTMENT OF TRANSPORTATION AND PUBLIC FACILITIES  
 NORTHERN REGION-AVIATION

APPROVED: Albert M.L. Beck DATE 1/13/2020  
 ALBERT M.L. BECK, P.E. PROJECT DELIVERY LEAD

BY	DATE	REVISIONS	FAA

BY	DATE	REVISIONS	FAA

**BETTLES AIRPORT**  
 BETTLES, ALASKA  
 ULTIMATE AIRPORT LAYOUT PLAN

SHEET  
**4** OF  
**12**



H:\info\_communities\bettles\02 alp file\2019 final alp\cad files\00419BTT\_ALP05-ALP05

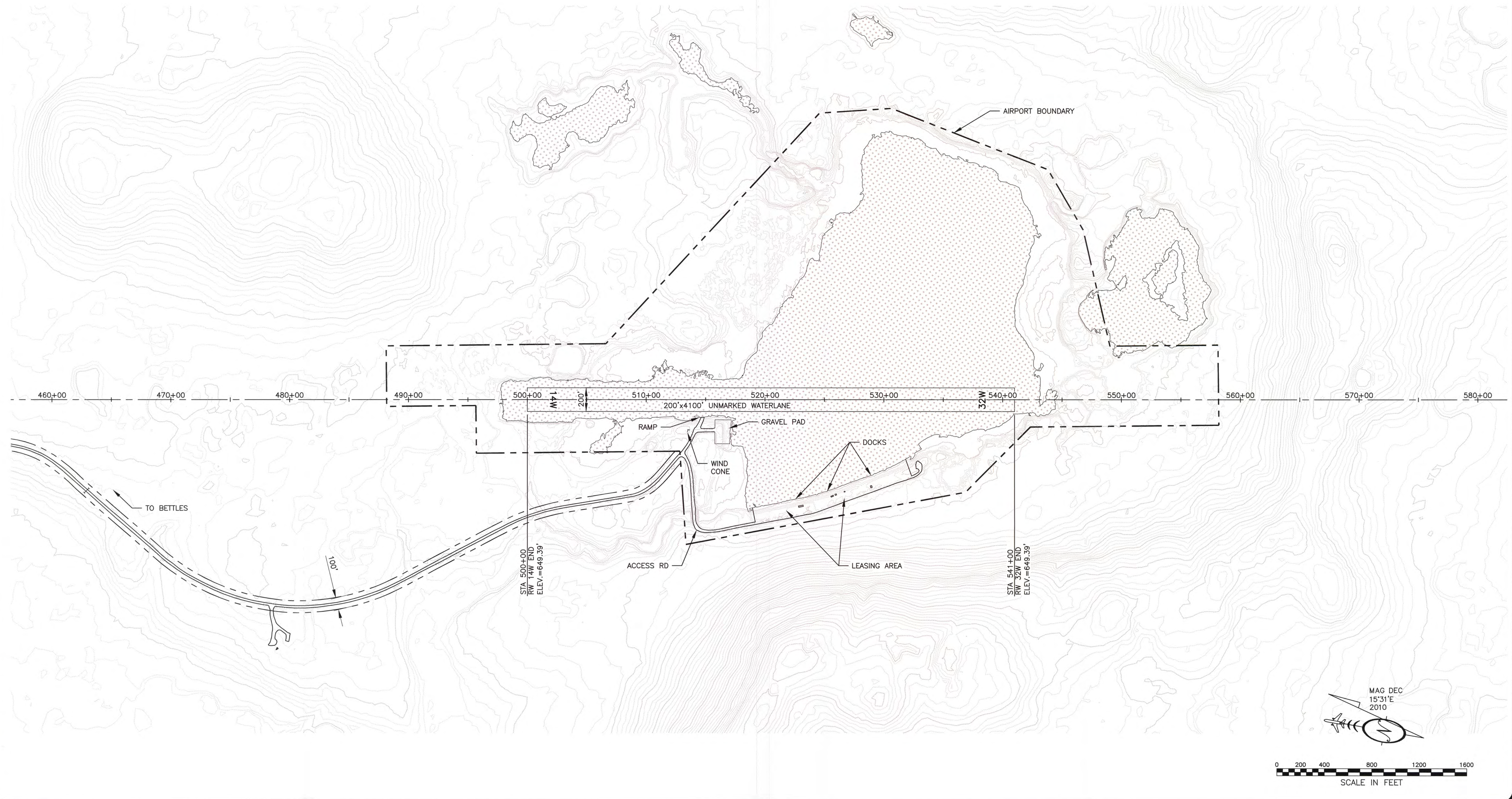

DESIGN MMM  
 DRAWN RWW  
 CHECKED CFJ

STATE OF ALASKA  
 DEPARTMENT OF TRANSPORTATION AND PUBLIC FACILITIES  
 NORTHERN REGION-AVIATION

APPROVED:  
*Albert M.L. Beck*  
 ALBERT M.L. BECK, P.E.

DATE 1/13/2020  
 PROJECT DELIVERY LEAD

BY	DATE	REVISIONS	FAA

BY	DATE	REVISIONS	FAA

BETTLES AIRPORT  
 BETTLES, ALASKA  
 EXISTING/ULTIMATE  
 AIRPORT LAYOUT PLAN  
 FOR LAKE WATERLANE

SHEET  
 5 OF  
 12



H:\info\_communities\bettles\02 alp file\2019 final alp\cad files\00419BTT\_ALP06--ALP06

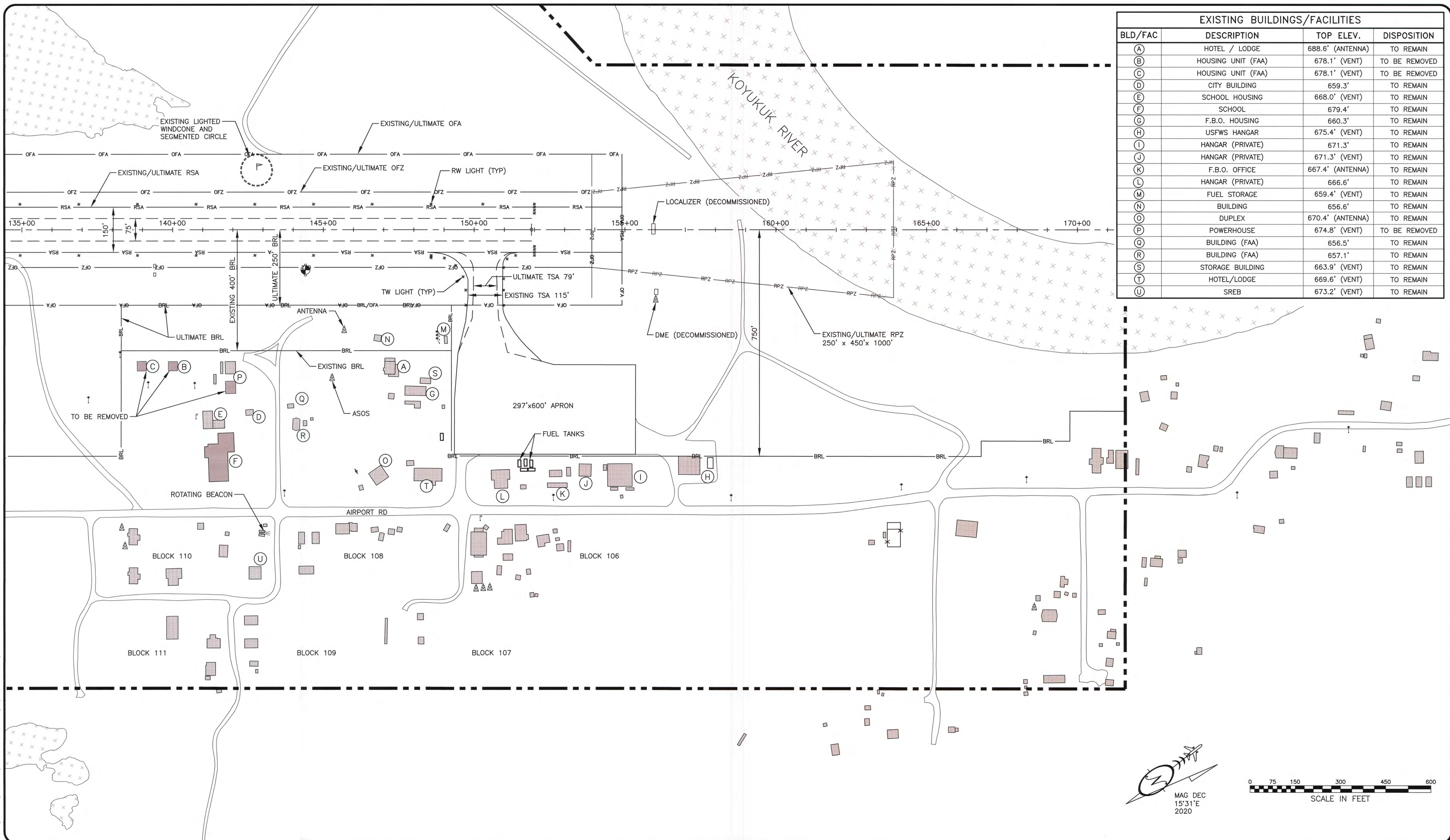

EXISTING BUILDINGS/FACILITIES			
BLD/FAC	DESCRIPTION	TOP ELEV.	DISPOSITION
(A)	HOTEL / LODGE	688.6' (ANTENNA)	TO REMAIN
(B)	HOUSING UNIT (FAA)	678.1' (VENT)	TO BE REMOVED
(C)	HOUSING UNIT (FAA)	678.1' (VENT)	TO BE REMOVED
(D)	CITY BUILDING	659.3'	TO REMAIN
(E)	SCHOOL HOUSING	668.0' (VENT)	TO REMAIN
(F)	SCHOOL	679.4'	TO REMAIN
(G)	F.B.O. HOUSING	660.3'	TO REMAIN
(H)	USFWS HANGAR	675.4' (VENT)	TO REMAIN
(I)	HANGAR (PRIVATE)	671.3'	TO REMAIN
(J)	HANGAR (PRIVATE)	671.3' (VENT)	TO REMAIN
(K)	F.B.O. OFFICE	667.4' (ANTENNA)	TO REMAIN
(L)	HANGAR (PRIVATE)	666.6'	TO REMAIN
(M)	FUEL STORAGE	659.4' (VENT)	TO REMAIN
(N)	BUILDING	656.6'	TO REMAIN
(O)	DUPLEX	670.4' (ANTENNA)	TO REMAIN
(P)	POWERHOUSE	674.8' (VENT)	TO BE REMOVED
(Q)	BUILDING (FAA)	656.5'	TO REMAIN
(R)	BUILDING (FAA)	657.1'	TO REMAIN
(S)	STORAGE BUILDING	663.9' (VENT)	TO REMAIN
(T)	HOTEL/LODGE	669.6' (VENT)	TO REMAIN
(U)	SREB	673.2' (VENT)	TO REMAIN

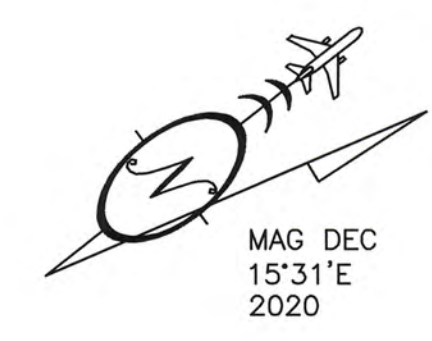

DESIGN MMM  
 DRAWN RWW  
 CHECKED CFJ

STATE OF ALASKA  
 DEPARTMENT OF TRANSPORTATION AND PUBLIC FACILITIES  
 NORTHERN REGION-AVIATION

APPROVED: *Albert M.L. Beck* DATE 11/2/2020  
 ALBERT M.L. BECK, P.E. PROJECT DELIVERY LEAD

BY	DATE	REVISIONS	FAA

BY	DATE	REVISIONS	FAA

BETTLES AIRPORT  
 BETTLES, ALASKA  
 EXISTING/INTERIM/ULTIMATE  
 TERMINAL PLAN

SHEET  
6 OF  
12



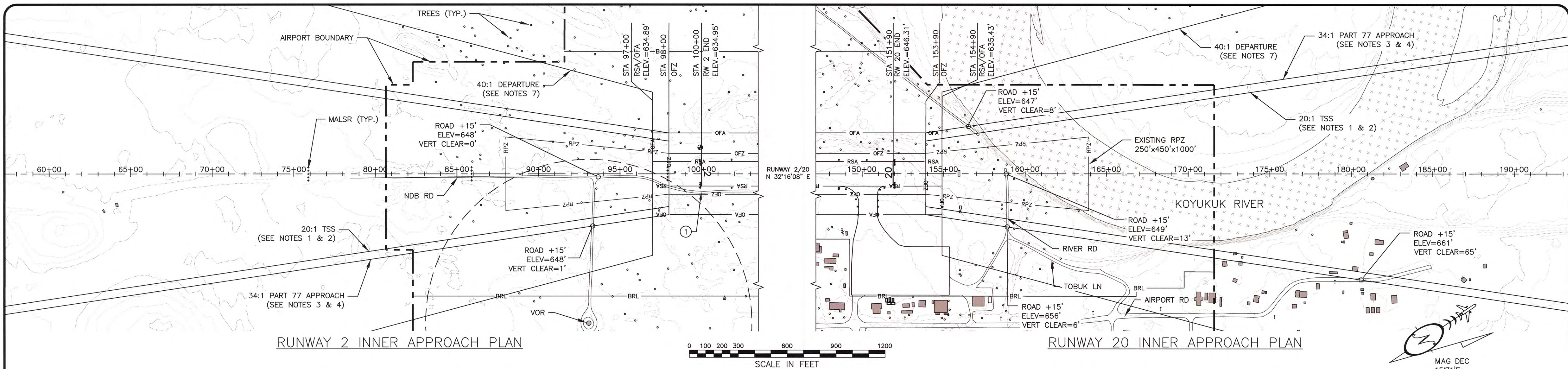

RUNWAY 2 INNER APPROACH PLAN

RUNWAY 20 INNER APPROACH PLAN

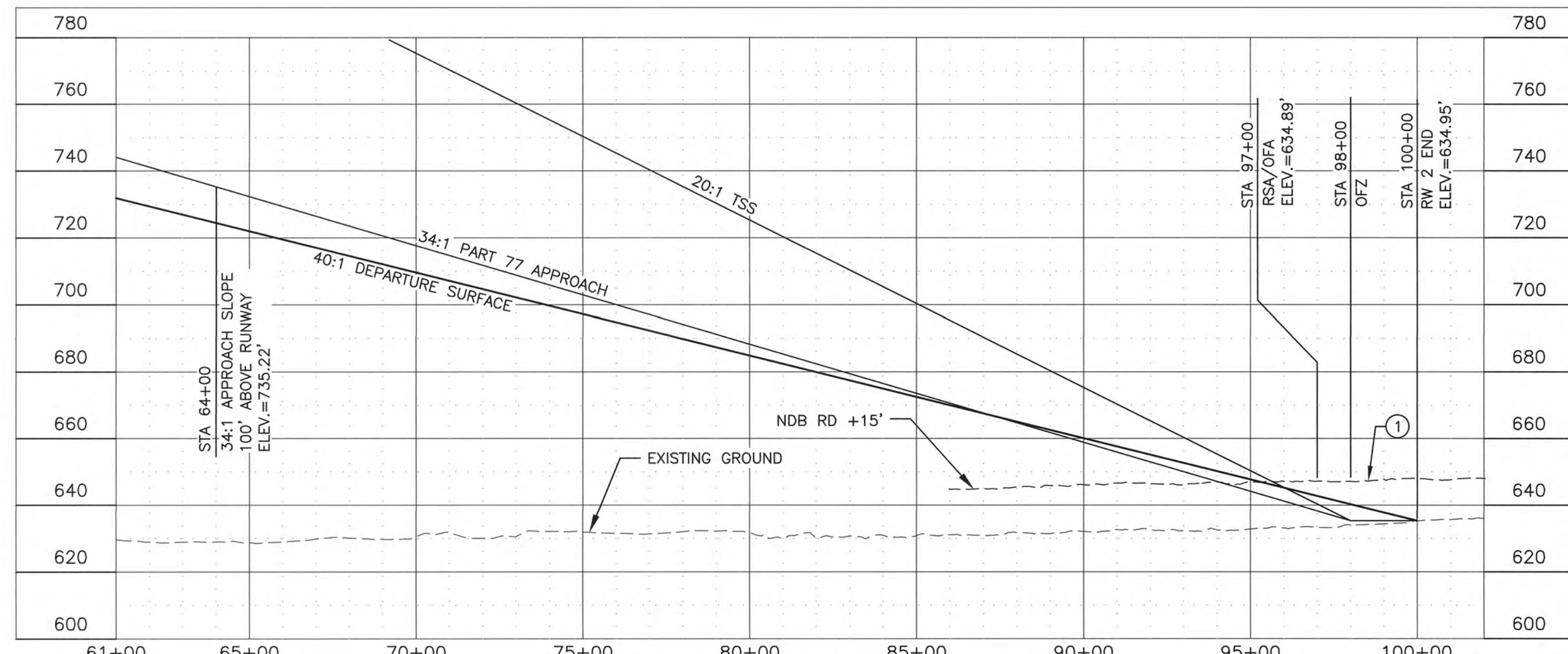
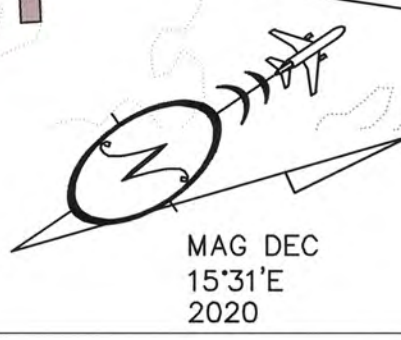
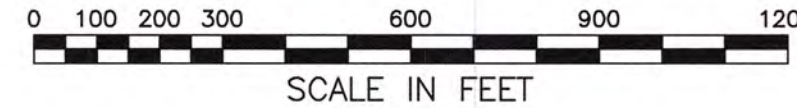

RUNWAY 2 INNER APPROACH PROFILE

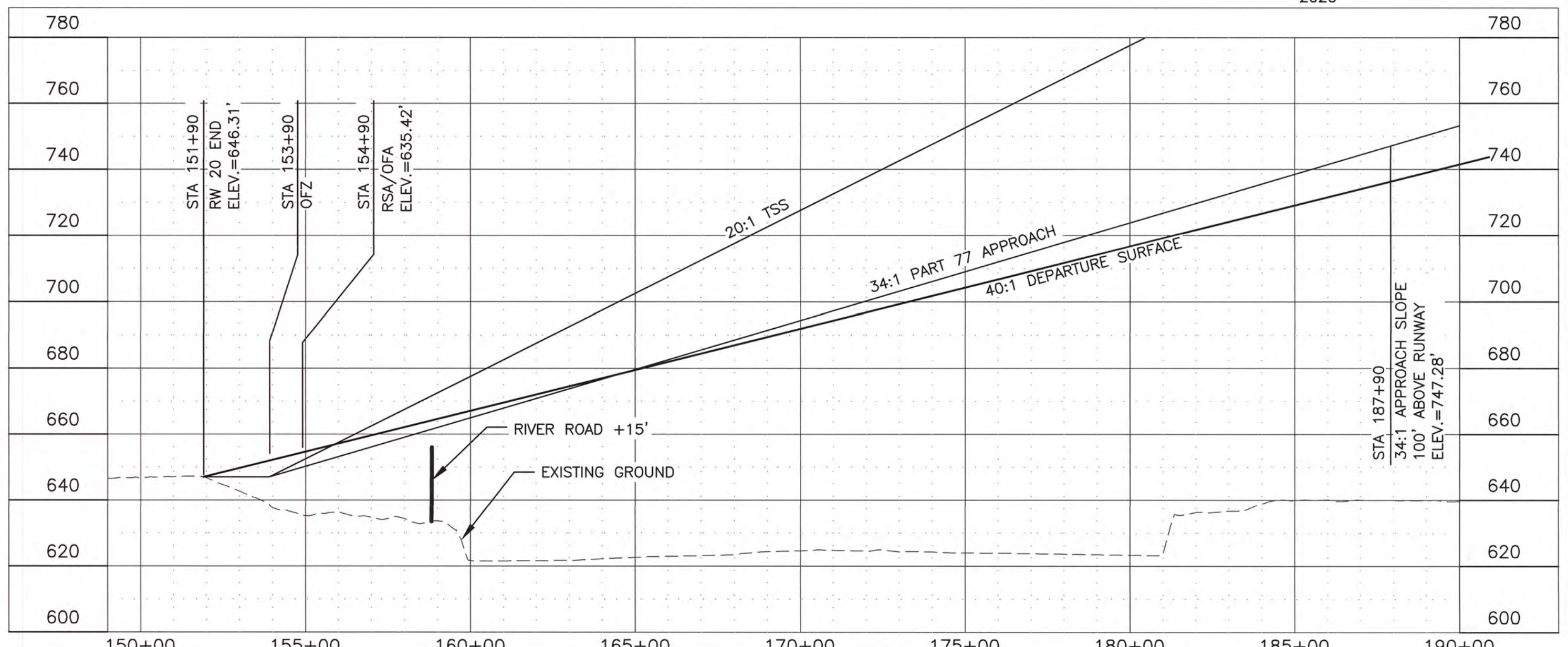

RUNWAY 20 INNER APPROACH PROFILE

ID #	DESCRIPTION	STATION/OFFSET	ELEV.	SURFACE ELEV.	SURFACE PENETRATED	SURFACE PENETRATION	DISPOSITION
①	ROAD +15' (HP)	98+00/80' RT	646'	633'	PART 77 / TSS	13'	RELOCATE

- NOTES:**
- (HP) = HIGH POINT OF OBSTRUCTION.
  - NDB RD PENETRATION EXTENDS FROM STA 94+65 TO 135+27.

- GENERAL NOTES:**
- TSS DIMENSION = 400'x3400'x10000' (TYPE 4, TABLE 3-2, AC 150/5300-13A)
  - TSS SLOPE EXTENDS 10000' AT 20:1
  - PART 77 APPROACH SURFACE DIMENSION = 500'x3500'x10000'
  - PART 77 APPROACH SURFACE EXTENDS 10000' AT 34:1
  - R/W 2/20 HAS OBSTACLE FREE ZONE PENETRATIONS CONSISTING OF TREES AND BUSHES
  - PART 77 ROAD OBSTRUCTION HEIGHTS ARE INCLUDED (10' FOR PRIVATE ROAD & 15' FOR PUBLIC ROAD)
  - 40:1 DEPARTURE SURFACE DIMENSION = 1000'x6466'x10200'

ID #	DESCRIPTION	STATION/OFFSET	ELEV.	SURFACE ELEV.	SURFACE PENETRATED	SURFACE PENETRATION	DISPOSITION
	NONE						

DESIGN MMM  
 DRAWN RWW  
 CHECKED CFJ

STATE OF ALASKA  
 DEPARTMENT OF TRANSPORTATION AND PUBLIC FACILITIES  
 NORTHERN REGION-AVIATION

APPROVED: Albert M.L. Beck DATE 1/13/2020  
 ALBERT M.L. BECK, P.E. PROJECT DELIVERY LEAD

BY	DATE	REVISIONS	FAA

BY	DATE	REVISIONS	FAA

BETTLES AIRPORT  
 BETTLES, ALASKA

EXISTING  
 INNER PORTION OF APPROACH SURFACE  
 R/W 2/20

SHEET  
 7 OF 12

H:\info\_communities\betties\02 alp file\2019 final alp files\0419BTT\_ALP07-ALP07



H:\info\_communities\betles\02 alp file\2019 final alp\cod files\00419BTT\_ALP07-ALP08

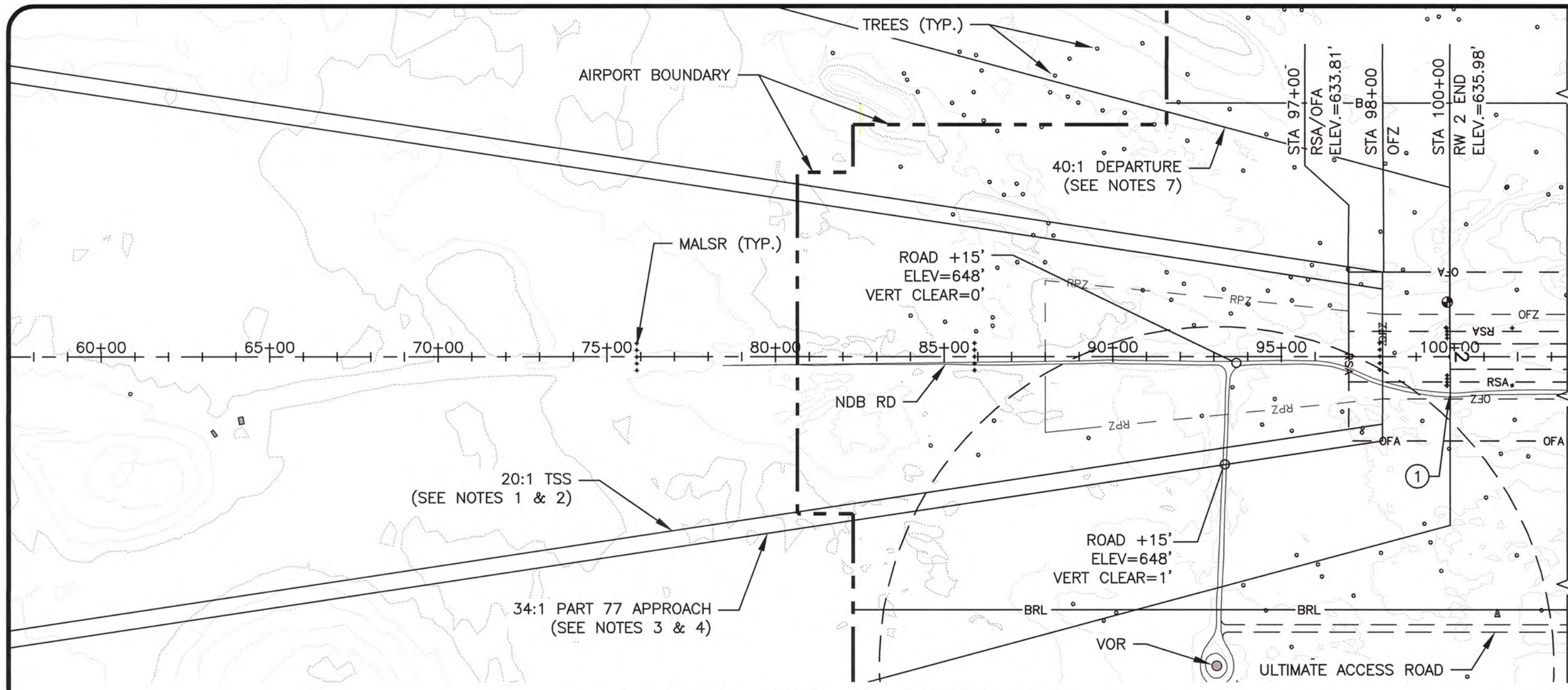

RUNWAY 2 INNER APPROACH PLAN

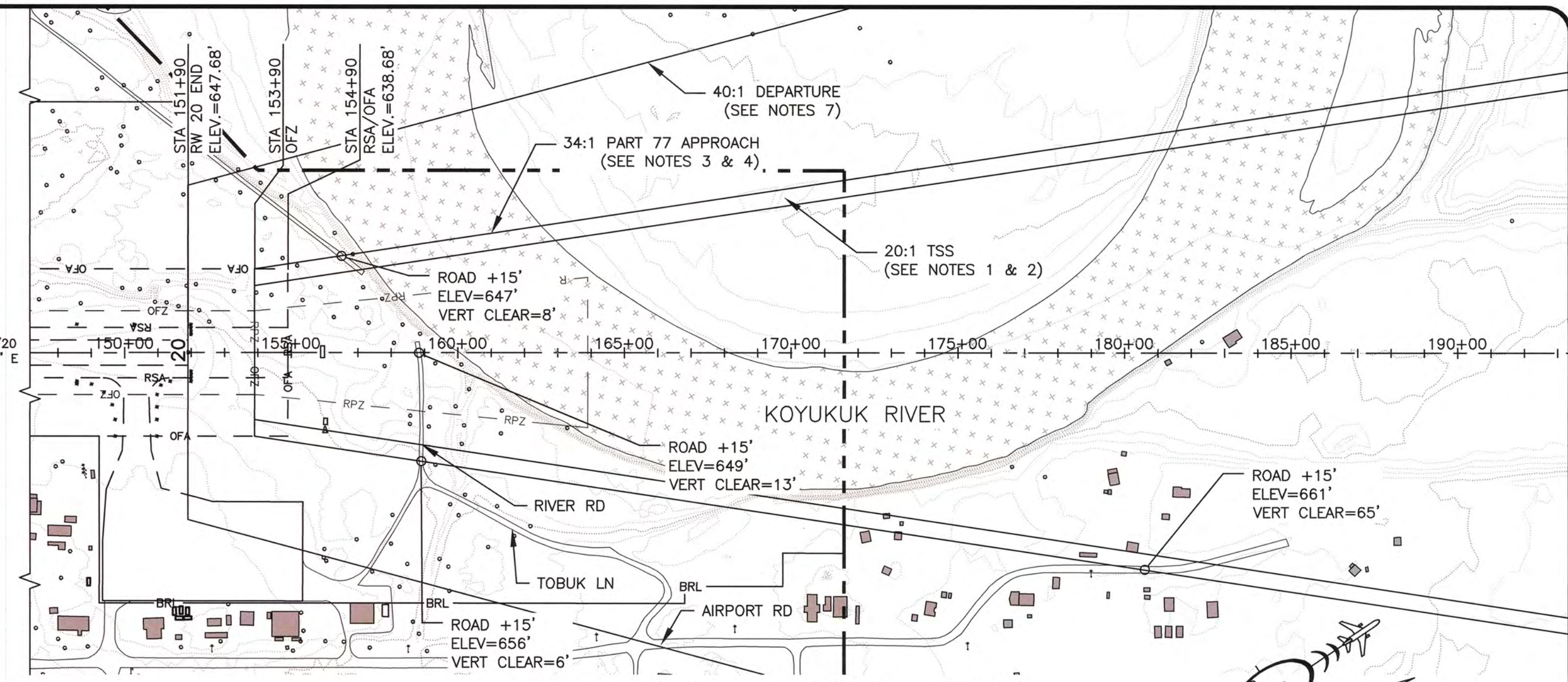
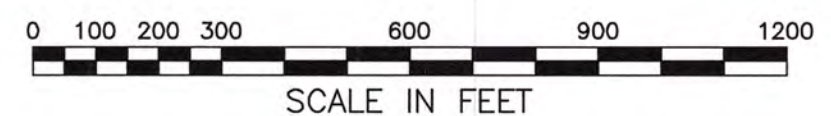

RUNWAY 20 INNER APPROACH PLAN

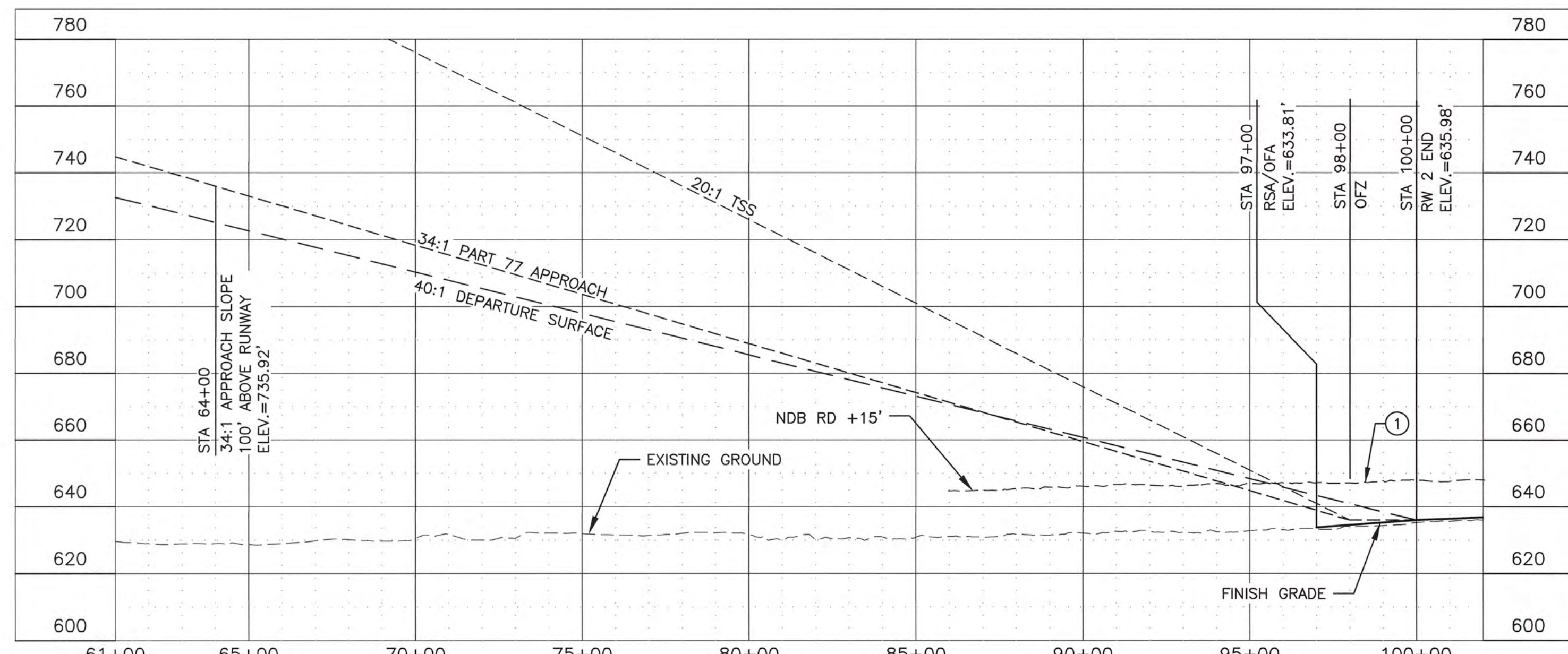
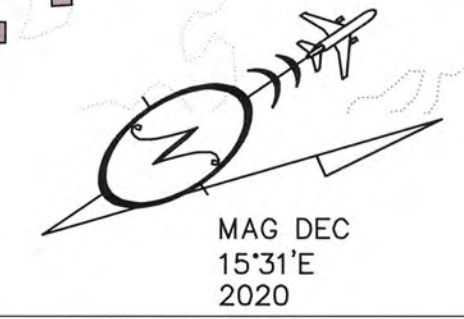

RUNWAY 2 INNER APPROACH PROFILE

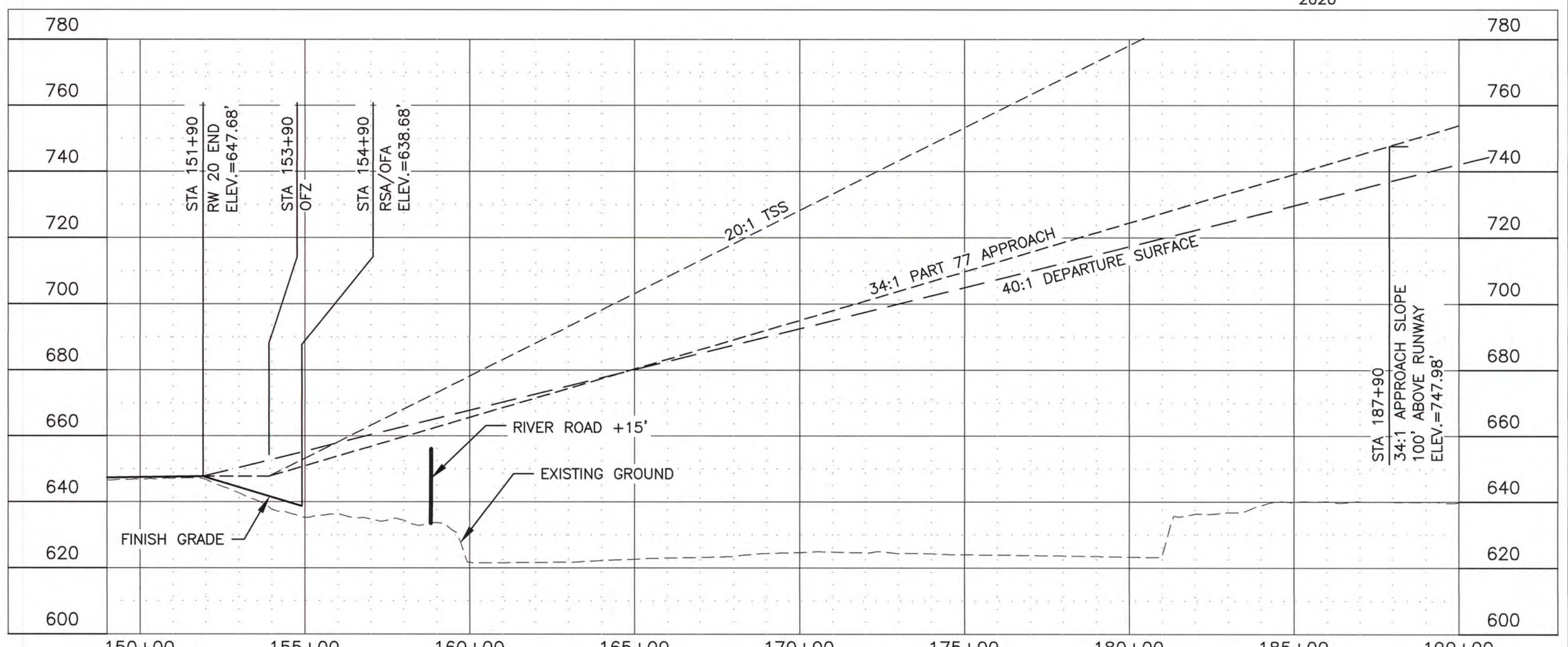

RUNWAY 20 INNER APPROACH PROFILE

OBSTRUCTION TABLE (INNER PORTION R/W 2)							
ID #	DESCRIPTION	STATION/OFFSET	ELEV.	SURFACE ELEV.	SURFACE PENETRATED	SURFACE PENETRATION	DISPOSITION
①	ROAD +15' (HP)	98+00/80' RT	646'	633'	PART 77 / TSS	13'	RELOCATE

- NOTES:**
- (HP) = HIGH POINT OF OBSTRUCTION.
  - NDB RD PENETRATION EXTENDS FROM STA 94+65 TO 135+27.

- GENERAL NOTES:**
- TSS DIMENSION = 400'x3400'x10000' (TYPE 4, TABLE 3-2, AC 150/5300-13A)
  - TSS SLOPE EXTENDS 10000' AT 20:1
  - PART 77 APPROACH SURFACE DIMENSION = 500'x3500'x10000'
  - PART 77 APPROACH SURFACE EXTENDS 10000' AT 34:1
  - R/W 2/20 HAS OBSTACLE FREE ZONE PENETRATIONS CONSISTING OF TREES AND BUSHES
  - PART 77 ROAD OBSTRUCTION HEIGHTS ARE INCLUDED (10' FOR PRIVATE ROAD & 15' FOR PUBLIC ROAD)
  - 40:1 DEPARTURE SURFACE DIMENSION = 1000'x6466'x10200'

OBSTRUCTION TABLE (INNER PORTION R/W 20)							
ID #	DESCRIPTION	STATION/OFFSET	ELEV.	SURFACE ELEV.	SURFACE PENETRATED	SURFACE PENETRATION	DISPOSITION
	NONE						

DESIGN MMM  
 DRAWN RWW  
 CHECKED CFJ

STATE OF ALASKA  
 DEPARTMENT OF TRANSPORTATION AND PUBLIC FACILITIES  
 NORTHERN REGION-AVIATION

APPROVED: Albert M.L. Beck DATE 1/13/2020  
 ALBERT M.L. BECK, P.E. PROJECT DELIVERY LEAD

BY	DATE	REVISIONS	FAA

BY	DATE	REVISIONS	FAA

BETTLES AIRPORT  
 BETTLES, ALASKA

ULTIMATE  
 INNER PORTION OF APPROACH SURFACE  
 R/W 2/20

SHEET  
 8 OF  
 12



H:\info\_communities\bettes\02 alp file\2019 final alp\alp\cod files\00419BTT\_ALP09-ALP09

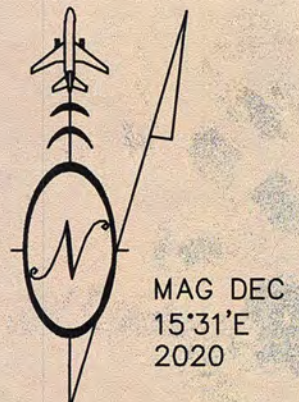
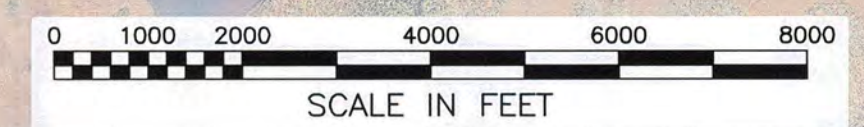
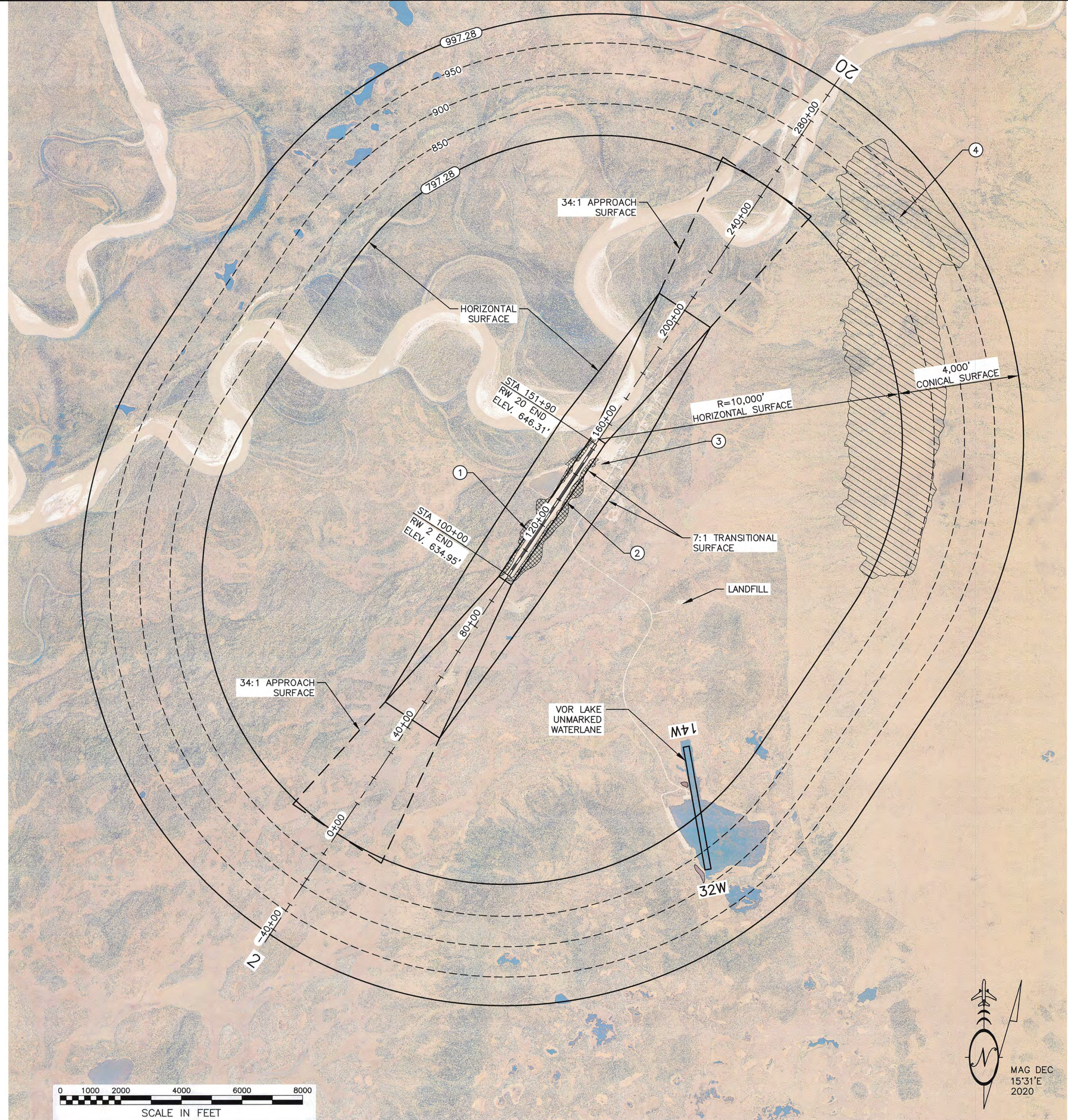

**LEGEND**

	AIRSPACE ELEVATION (SURFACE DIVIDERS)
	AIRSPACE SURFACE DIVIDERS (NON CONTROLLING)
	AIRSPACE ELEVATION (50' INCREMENTS)
	EXISTING GROUND ELEVATIONS
	RUNWAY CENTERLINE (EXTENDED)
	TERRAIN OBSTRUCTION EXTENTS
	TREE OBSTRUCTION EXTENTS

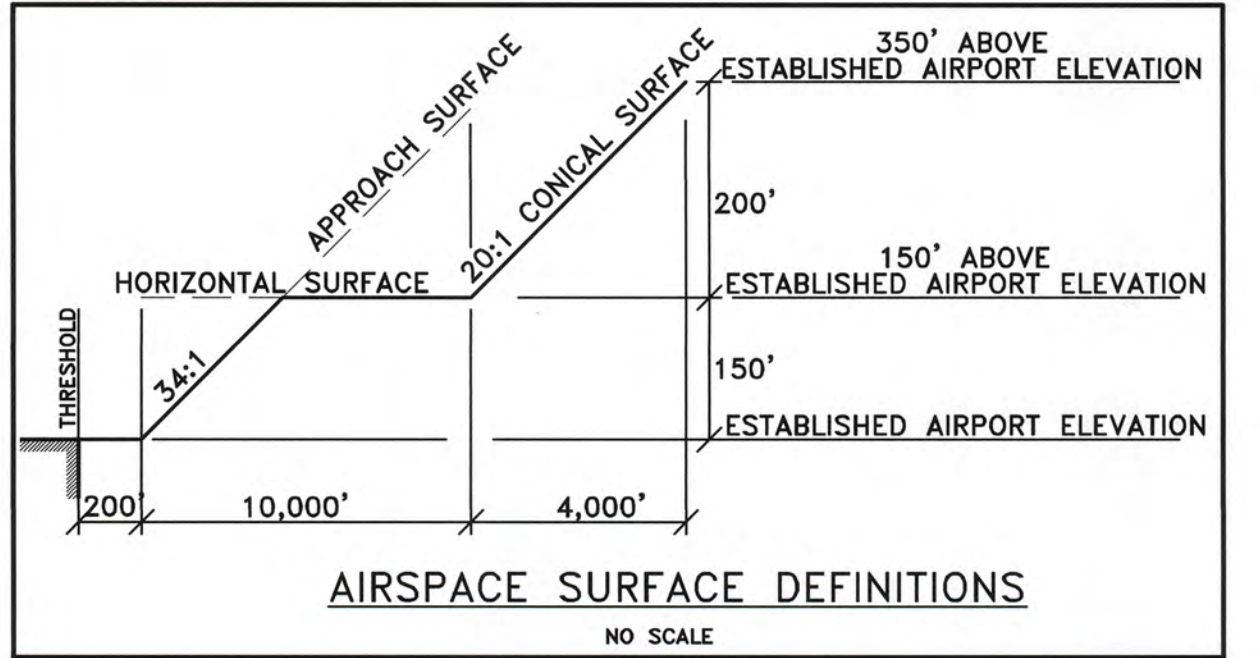

**ULTIMATE RUNWAY FAR PART 77 DIMENSIONS OTHER THAN UTILITY, NPA, ≥1 S.M.**

DESCRIPTION	RUNWAY 2/20
ESTABLISHED AIRPORT ELEVATION	647.28'
RUNWAY THRESHOLD ELEVATION	RW 2: 634.95' / RW 20: 646.31'
PRIMARY SURFACE DIMENSION	500' x 5590'
HORIZONTAL SURFACE ELEVATION	797.28'
HORIZONTAL SURFACE RADIUS	10000'
APPROACH SURFACE DIMENSION	500' x 3500' x 10000'
APPROACH SURFACE SLOPE	34:1
CONICAL SURFACE WIDTH	4000' @ 20:1
TRANSITIONAL SURFACE SLOPE	7:1

**FAR PART 77 SURFACE OBSTRUCTION TABLE**

ID #	DESCRIPTION	STATION/OFFSET	ELEV.	SURFACE PENETRATED	SURFACE ELEV.	SURFACE PENETRATION	DISPOSITION
①	TREES/BUSHES (HP)	116+08/273' LT	682.8'	PRIMARY/TRANSITIONAL	641.9'	40.9'	REMOVE
②	TREES/BUSHES (HP)	130+69/251' RT	686.0'	PRIMARY/TRANSITIONAL	644.3'	41.7'	REMOVE
③	ANTENNA	145+98/343' RT	688.6'	TRANSITIONAL	678.9'	9.7'	OBSTRUCTION LIGHTING
④	TERRAIN (HP)	269+90/4230' RT	1075'	HORIZONTAL/CONICAL	915'	160'	TO REMAIN

**NOTES:**

- (HP) = HIGH POINT OF TERRAIN OBSTRUCTION.
- STATION AND OFFSET ARE IN RELATION TO RUNWAY 2/20 UNLESS OTHERWISE NOTED.

**GENERAL NOTES:**

- REFER TO INNER PORTION OF APPROACH SURFACE (SHEETS 7) FOR CLOSE IN OBSTRUCTIONS ANALYZED WITH THE PART 77 APPROACH AND TSS.
- THERE ARE NO KNOWN HEIGHT RESTRICTIONS.
- REFER TO THE AIRPORT LAYOUT PLAN (SHEETS 3 & 4) FOR BUILDING LOCATIONS AND ELEVATIONS.
- GROUND SURFACE INFORMATION WAS PROVIDED BY AN AERIAL MAPPING SUBCONTRACTOR. A CAREFUL COMPARISON WITH SURVEYED DATA WAS MADE TO ENSURE THAT ALL INFORMATION MEETS THE ACCURACY REQUIREMENTS ESTABLISHED IN AC 150/5300-18B.
- REFER TO THE AC 150/5395-1B, PARAGRAPH 3.2.5.1 FOR UNMARKED WATERLANE.

DESIGN MMM  
 DRAWN RWW  
 CHECKED CFJ

STATE OF ALASKA  
 DEPARTMENT OF TRANSPORTATION AND PUBLIC FACILITIES  
 NORTHERN REGION-AVIATION  
 APPROVED:   
 ALBERT M.L. BECK, P.E. DATE 1/13/2020  
 PROJECT DELIVERY LEAD

BY	DATE	REVISIONS	FAA

BY	DATE	REVISIONS	FAA

BETTLES AIRPORT  
 BETTLES, ALASKA  
 AIRPORT AIRSPACE  
 (FAR PART 77)

SHEET  
9 OF  
 12



H:\info\_communities\betties\02 alp file\2019 final alp\cad files\00419BTT\_ALP10-ALP10

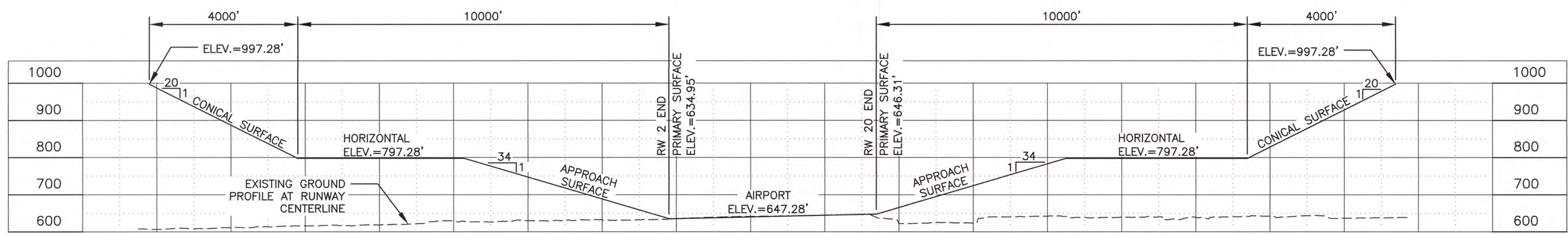
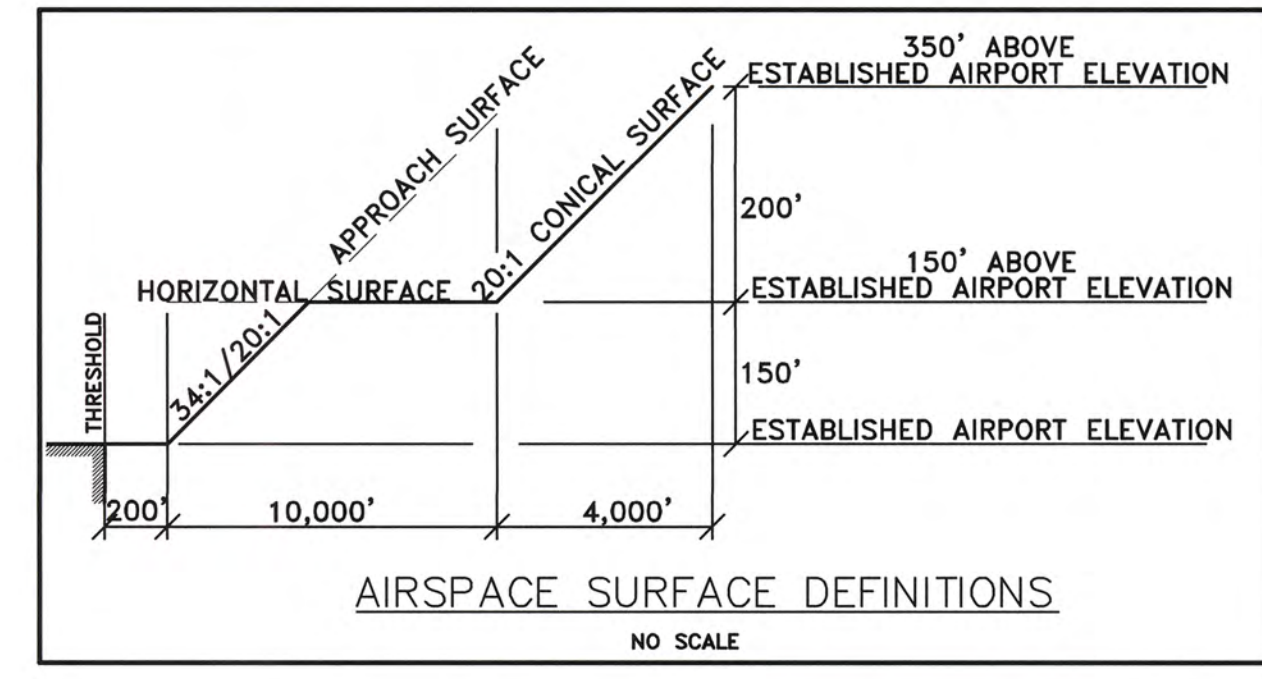

RUNWAY 2/20 - PROFILE

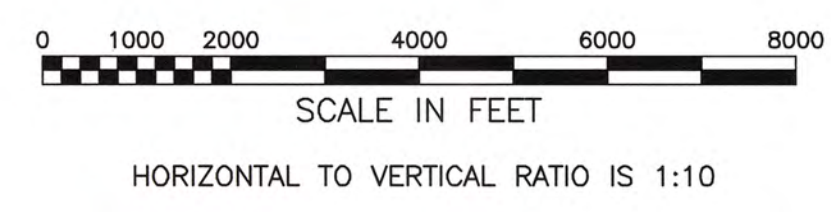

DESIGN MMM  
DRAWN RWW  
CHECKED CFJ

**STATE OF ALASKA**  
DEPARTMENT OF TRANSPORTATION AND PUBLIC FACILITIES  
NORTHERN REGION-AVIATION

APPROVED: *Albert M.L. Beck* DATE 1/13/2020  
ALBERT M.L. BECK, P.E. PROJECT DELIVERY LEAD

BY	DATE	REVISIONS	FAA

BY	DATE	REVISIONS	FAA

**BETTLES AIRPORT**  
BETTLES, ALASKA  
AIRPORT AIRSPACE PROFILES  
(FAR PART 77)

SHEET  
**10** OF  
12



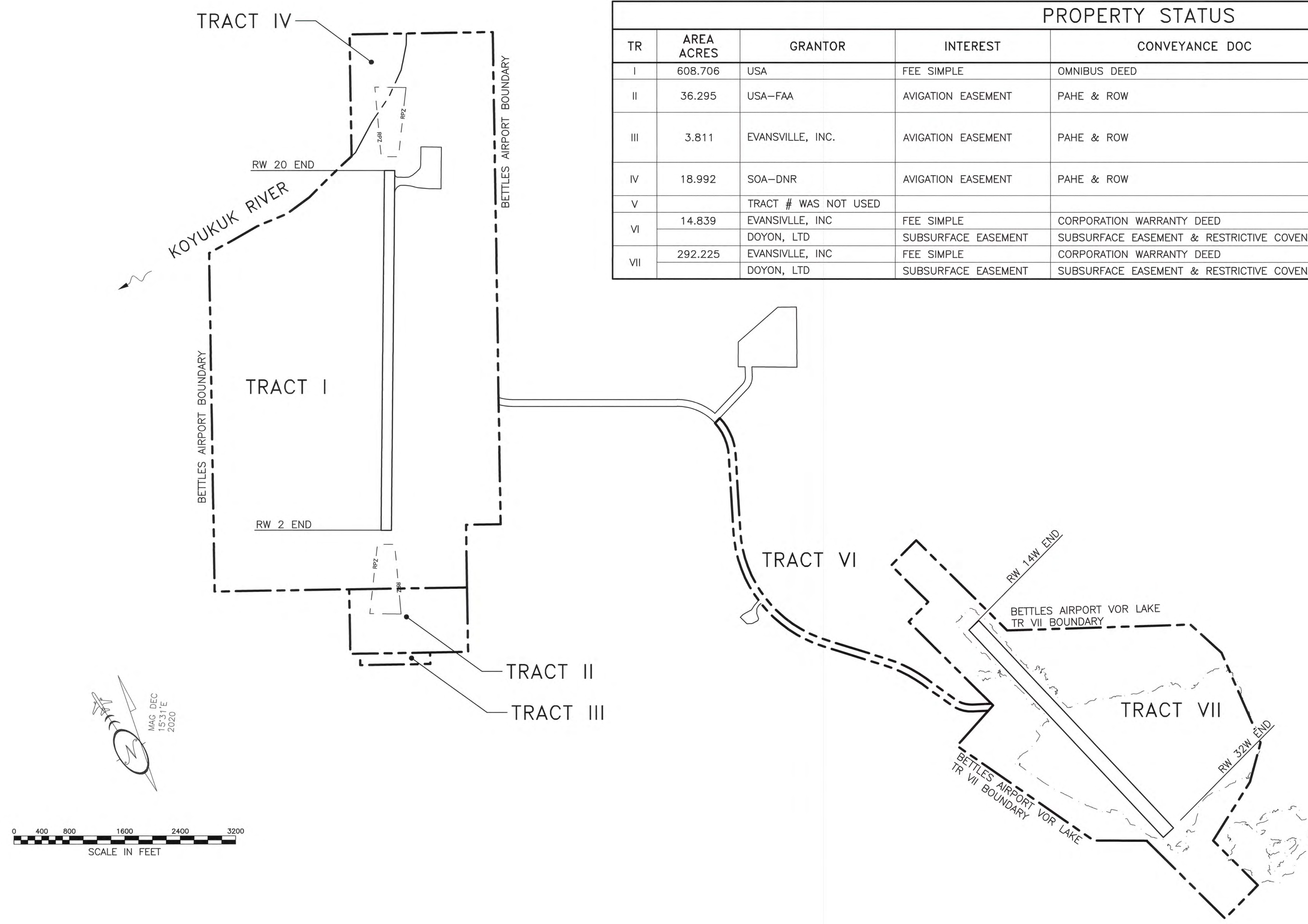

PROPERTY STATUS							
TR	AREA ACRES	GRANTOR	INTEREST	CONVEYANCE DOC	ACQUIRED DATE	FAA GRANT #	RECORDING INFO
I	608.706	USA	FEE SIMPLE	OMNIBUS DEED	05/27/1966	N/A	FAIRBANKS 193/63-65
II	36.295	USA-FAA	AVIGATION EASEMENT	PAHE & ROW	08/05/1988	N/A	FAIRBANKS 583/288-293
III	3.811	EVANSVILLE, INC.	AVIGATION EASEMENT	PAHE & ROW	12/15/1988	N/A	FAIRBANKS 604/381-387 & 376-380
IV	18.992	SOA-DNR	AVIGATION EASEMENT	PAHE & ROW	12/12/1988	N/A	FAIRBANKS 604/370-375
V		TRACT # WAS NOT USED					
VI	14.839	EVANSVILLE, INC	FEE SIMPLE	CORPORATION WARRANTY DEED	06/28/1999	3-02-0030-04	FAIRBANKS 1174/893
		DOYON, LTD	SUBSURFACE EASEMENT	SUBSURFACE EASEMENT & RESTRICTIVE COVENANT	06/02/1999	3-02-0030-04	FAIRBANKS 1174/878
VII	292.225	EVANSVILLE, INC	FEE SIMPLE	CORPORATION WARRANTY DEED	06/28/1999	3-02-0030-04	FAIRBANKS 1174/893
		DOYON, LTD	SUBSURFACE EASEMENT	SUBSURFACE EASEMENT & RESTRICTIVE COVENANT	06/02/1999	3-02-0030-04	FAIRBANKS 1174/878

DESIGN MMM  
 DRAWN RWW  
 CHECKED CFJ

STATE OF ALASKA  
 DEPARTMENT OF TRANSPORTATION AND PUBLIC FACILITIES  
 NORTHERN REGION-AVIATION  
 APPROVED: *Albert M.L. Beck* DATE 1/13/2020  
 ALBERT M.L. BECK, P.E. PROJECT DELIVERY LEAD

BY	DATE	NO.	REVISIONS	FAA



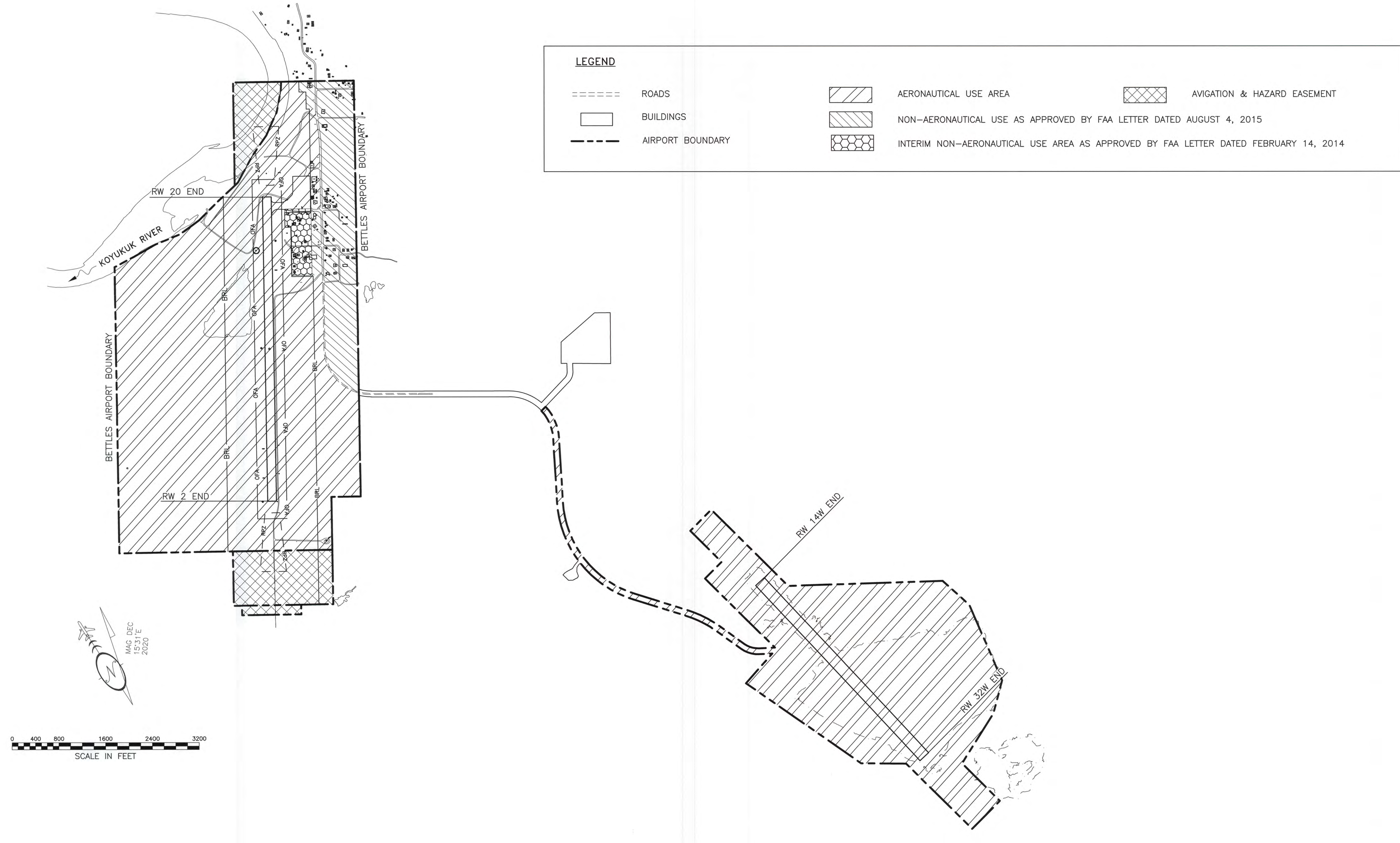

BY	DATE	NO.	REVISIONS	FAA

BETTLES AIRPORT  
 BETTLES, ALASKA  
 AIRPORT PROPERTY MAP



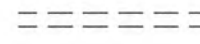
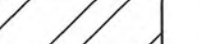

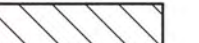
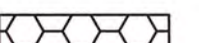
**LEGEND**

-  ROADS
-  AERONAUTICAL USE AREA
-  AVIGATION & HAZARD EASEMENT
-  BUILDINGS
-  NON-AERONAUTICAL USE AS APPROVED BY FAA LETTER DATED AUGUST 4, 2015
-  INTERIM NON-AERONAUTICAL USE AREA AS APPROVED BY FAA LETTER DATED FEBRUARY 14, 2014
-  AIRPORT BOUNDARY

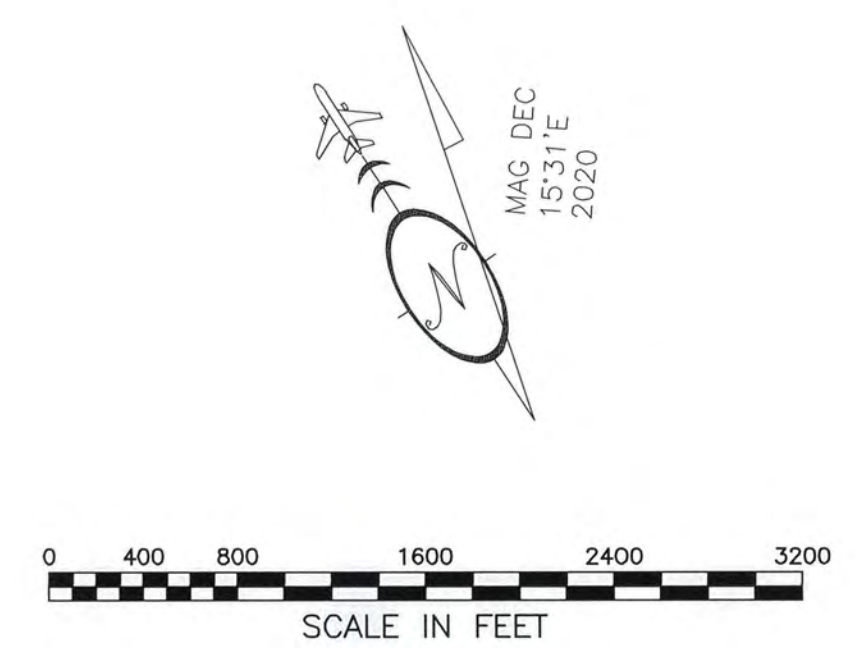

DESIGN MMM  
DRAWN RWW  
CHECKED CFJ

**STATE OF ALASKA**  
DEPARTMENT OF TRANSPORTATION AND PUBLIC FACILITIES  
NORTHERN REGION-AVIATION

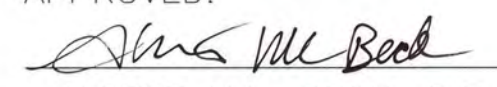
APPROVED:  DATE 1/13/2020  
ALBERT M.L. BECK, P.E. PROJECT DELIVERY LEAD

BY	DATE	NO.	REVISIONS	FAA

BY	DATE	NO.	REVISIONS	FAA

**BETTLES AIRPORT**  
BETTLES, ALASKA  
AIRPORT PROPERTY MAP

SHEET  
**12** OF  
12